

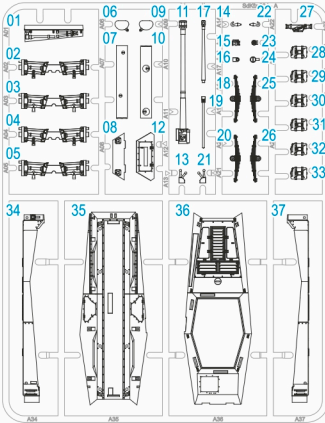

Product Code: **280138**
221130-2

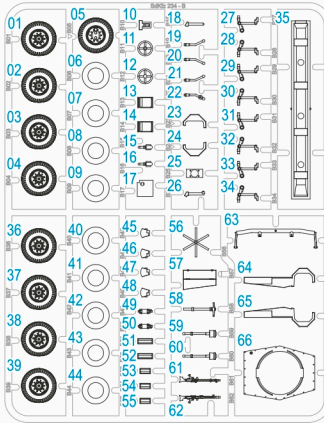

A



B

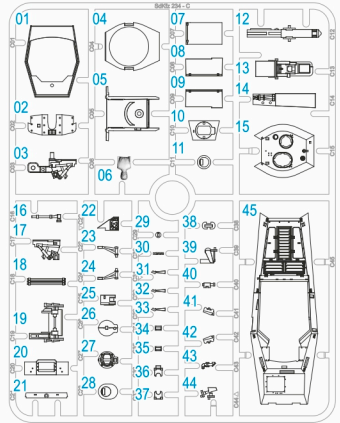

C



- When you use glue or paint, do not use near a naked flame, and use in a well-ventilated area.
- When assembling this kit, tools including knives are used. Extra care should be taken to avoid personal injury.
- Keep out of reach of small children.

Read carefully and fully understand the instructions before commencing assembly. Model supplied unpainted. Bases, scenery, glue and paint not included. Legend used:



Choices



Optional



No glue



Drill hole



Bend



Cut or trim with care

 Please use **ABS Plastic Cement** for our plastic kits.

WARNING

- THIS IS NOT A TOY
- INTENDED FOR COLLECTORS OF AGE 14 AND ABOVE
- CONTAINS SMALL PARTS AND POINTED COMPONENTS
- NOT SUITABLE FOR CHILDREN UNDER 6 YEARS OLD
- MODEL MAY VARY FROM IMAGE ON BOX
- READY TO ASSEMBLE PRECISION MODEL KIT

1

Lower Chassis Assembly

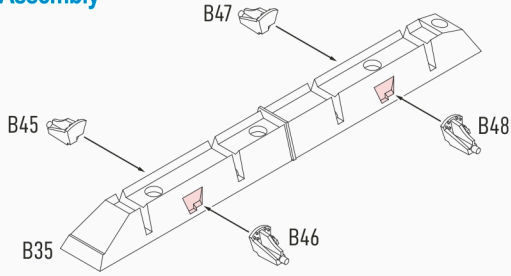

2

Lower Chassis Assembly

Steering Components

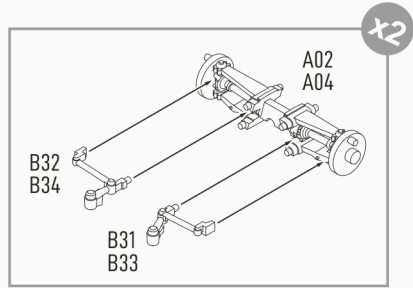
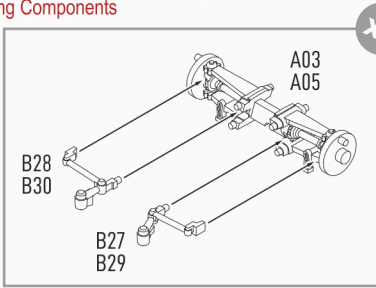

3

Lower Chassis Assembly

Steering & Lower Hull

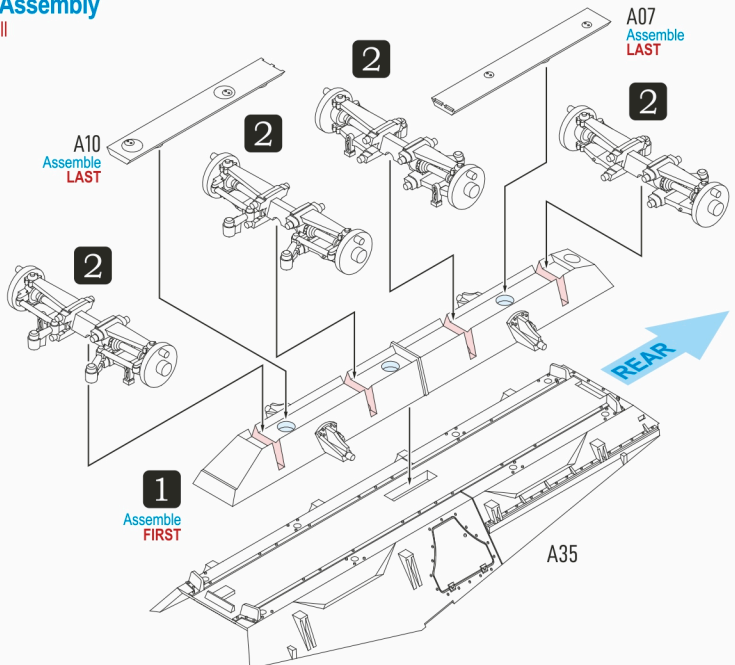
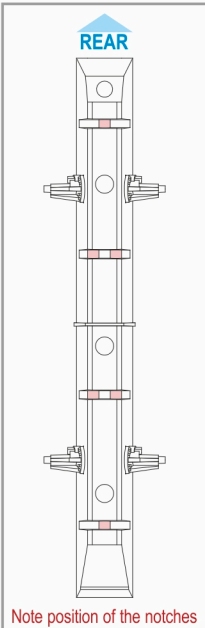

Note position of the notches

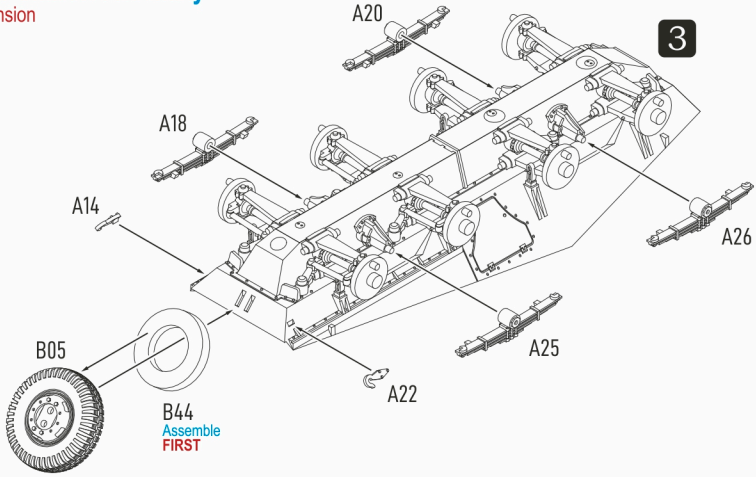
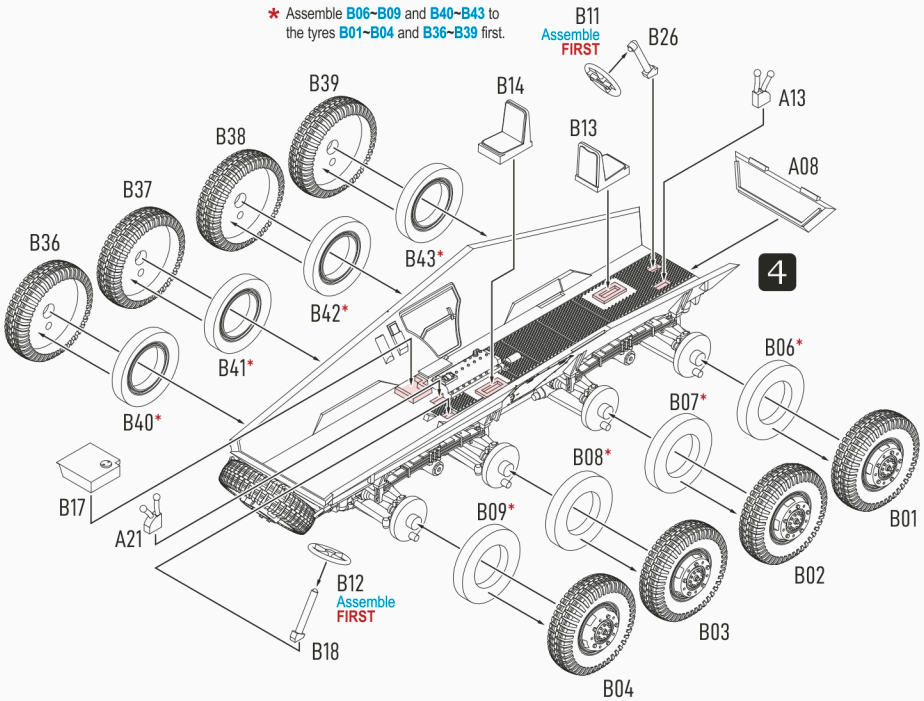
4**Lower Chassis Assembly**
Suspension**5****Lower Chassis Assembly**
Wheels & Internal Fixtures

6a

Punching Holes for Options



6b

Left Side Fender Assembly

for SdKfz 234/1, SdKfz 234/2, and SdKfz 234/3

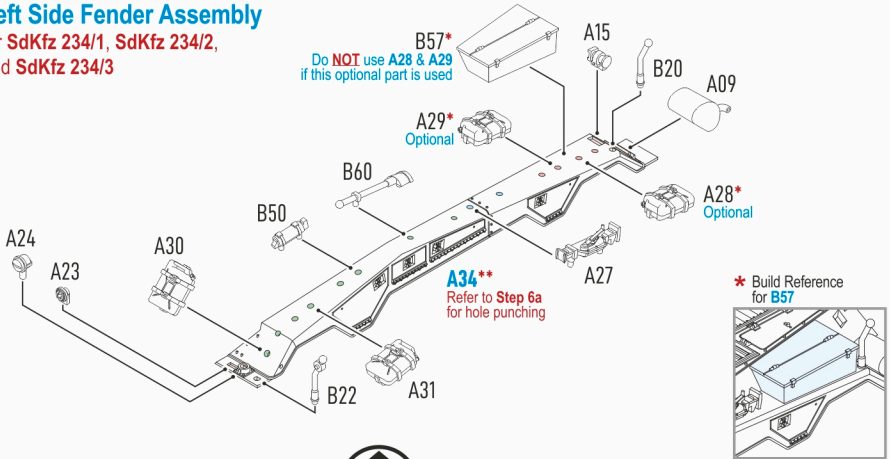

6c

Left Side Fender Assembly

for SdKfz 234/4 Only

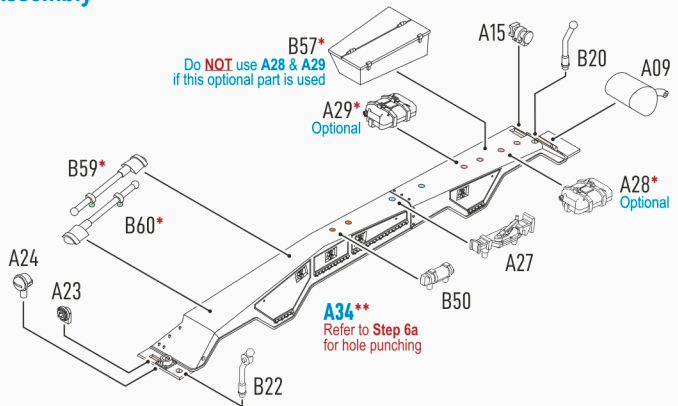
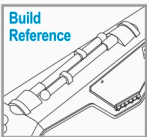
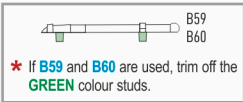

6d

Left Side Fender

Final Assembly

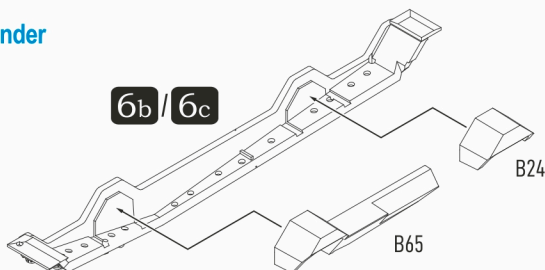

7a

Punching Holes for Options

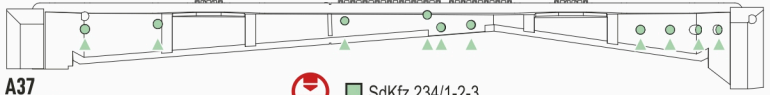

A37
Backside

SdKfz 234/1-2-3

7b

Right Side Fender Assembly

for SdKfz 234/1, SdKfz 234/2, and SdKfz 234/3

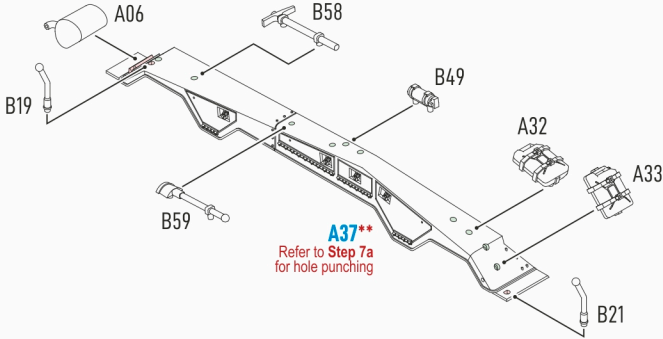

7c

Right Side Fender Assembly

for SdKfz 234/4 Only

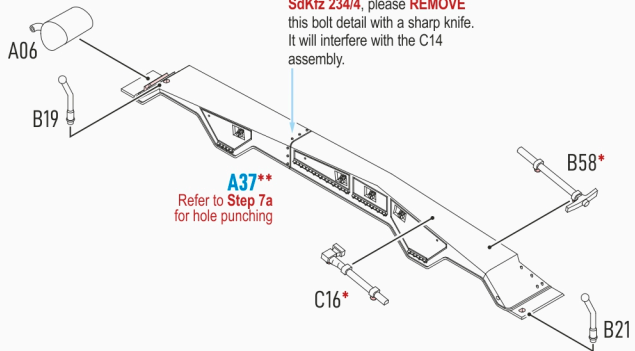
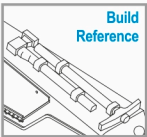
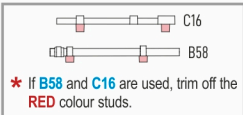

7d

Right Side Fender

Final Assembly

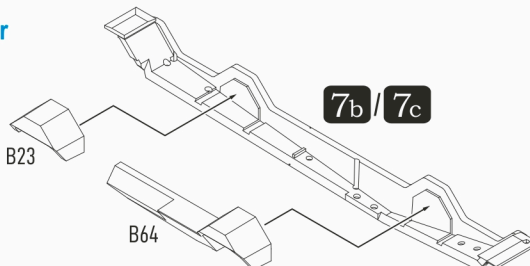

9b

Gun Turret for SdKfz 234/2

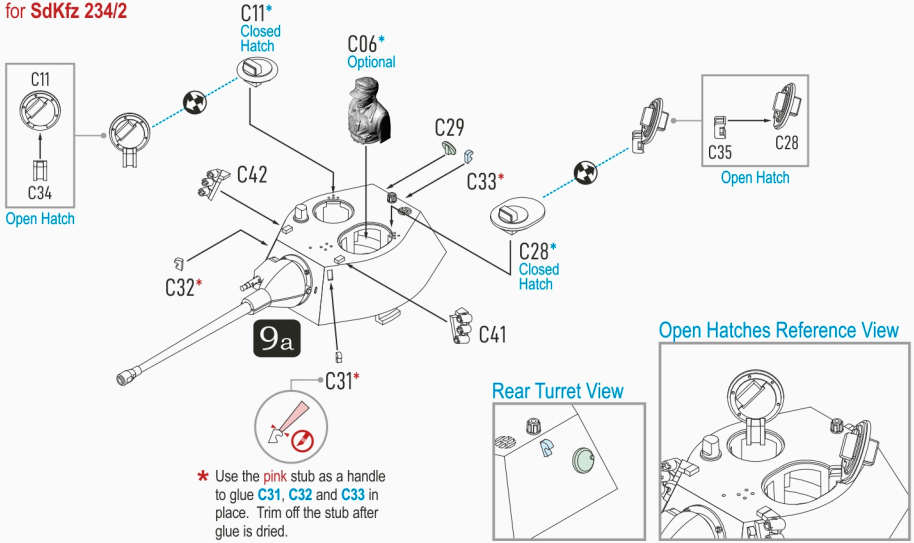

10a

Chassis Assembly for SdKfz 234/1 & SdKfz 234/2

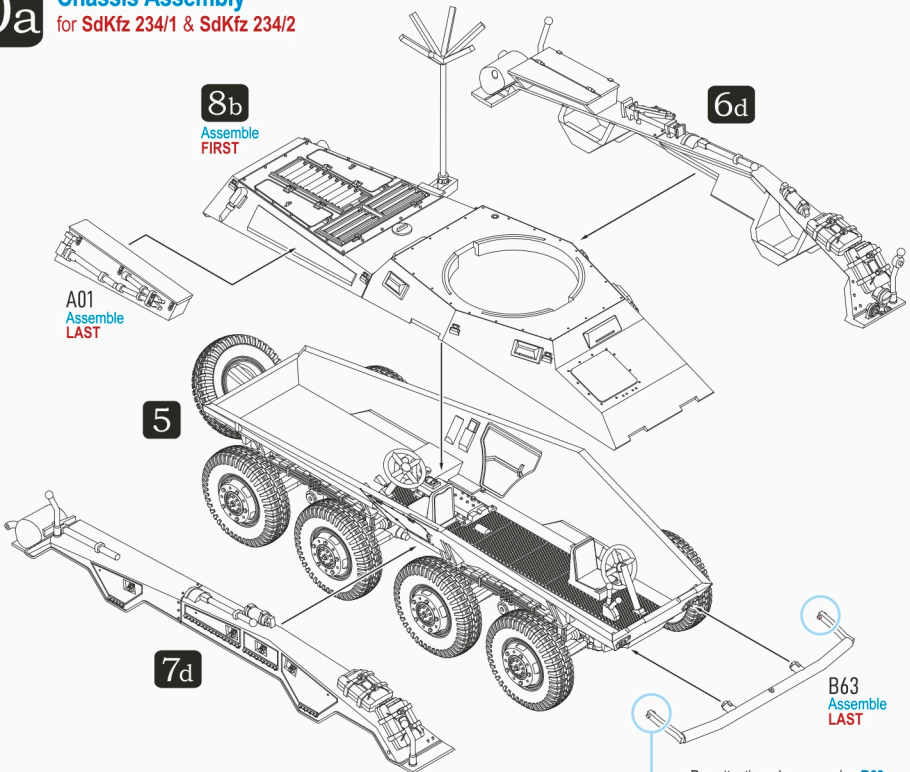

Pay attention when removing B63 from the sprue. Do NOT remove details on the tip of B36 as indicated.

10b

Final Assembly

for SdKfz 234/1 & SdKfz 234/2

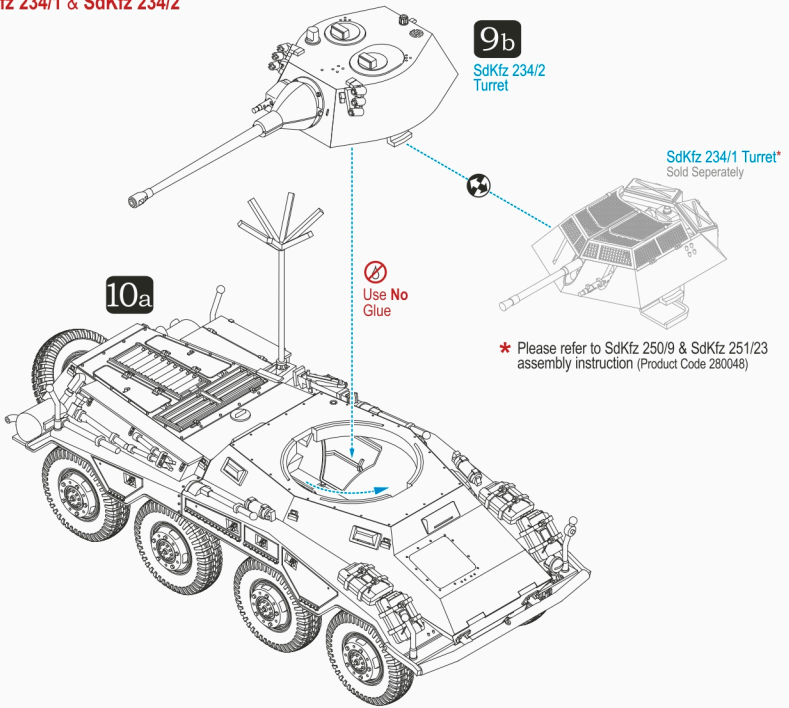

SdKfz 234/4 - Equipped with a 7.5cm PaK 40 L/46 gun in open-topped superstructure replacing the traditional turret on the SdKfz 234/2.

SKIP TO STEP 14 ▶

11

Turret Assembly

for SdKfz 234/3

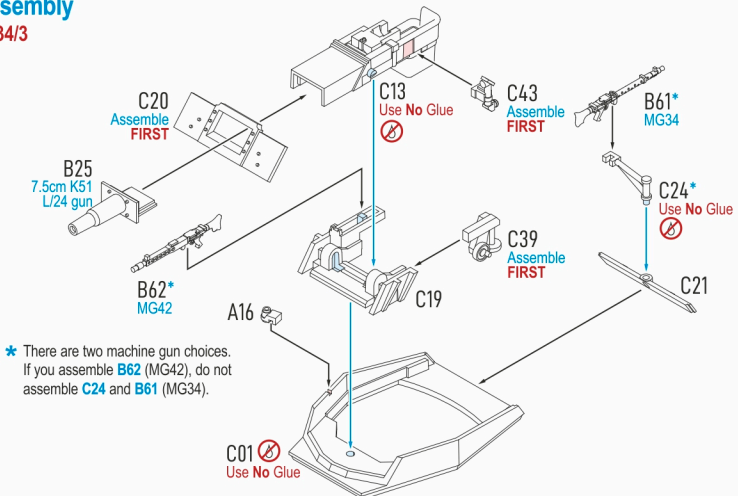

12

Upper Chassis Assembly for SdKfz 234/3

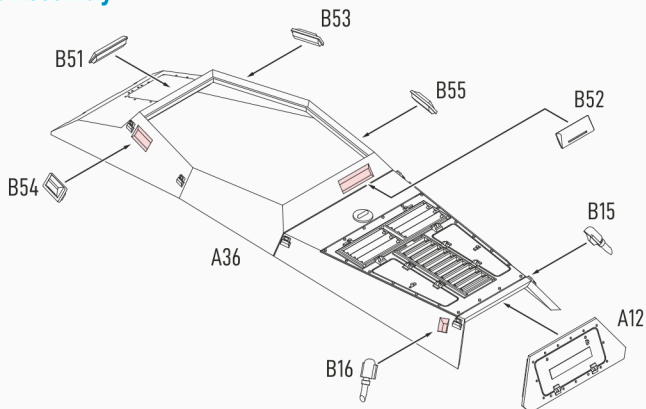

13a

Chassis Assembly for SdKfz 234/3

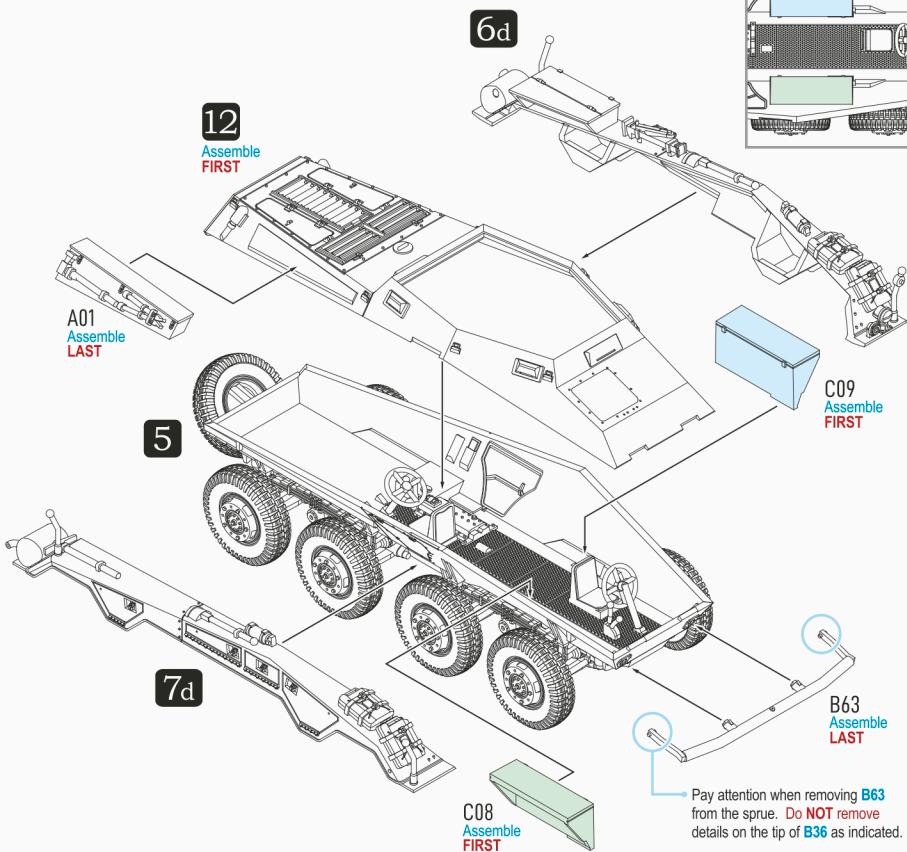

Top Down View of C08 & C09

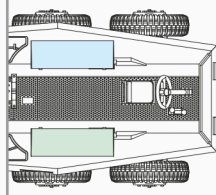

12

Assemble
FIRST

A01
Assemble
LAST

5

7d

C08
Assemble
FIRST

C09
Assemble
FIRST

B63
Assemble
LAST

Pay attention when removing B63 from the sprue. Do NOT remove details on the tip of B36 as indicated.

13b

Final Assembly for SdKfz 234/3

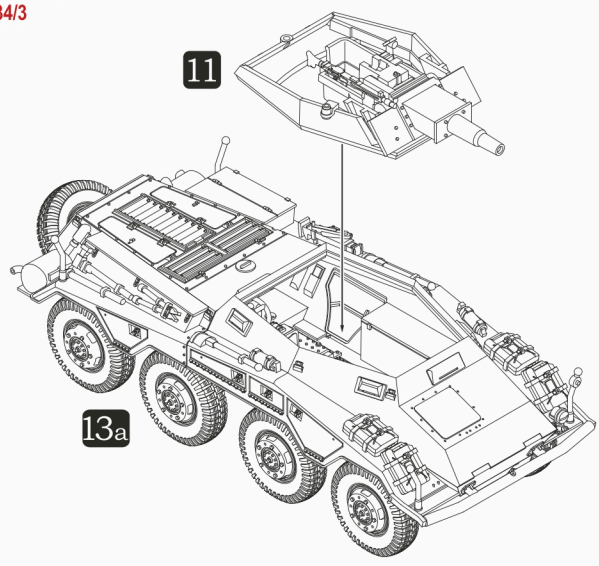

14

Lower Chassis Assembly for SdKfz 234/4

Top View Position Reference

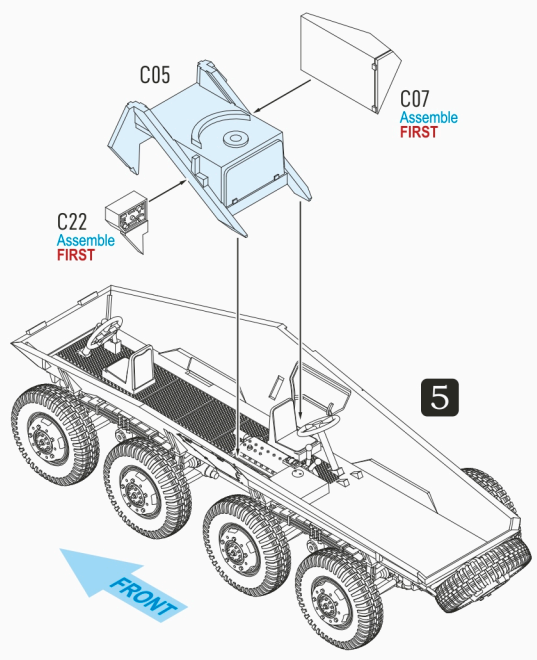
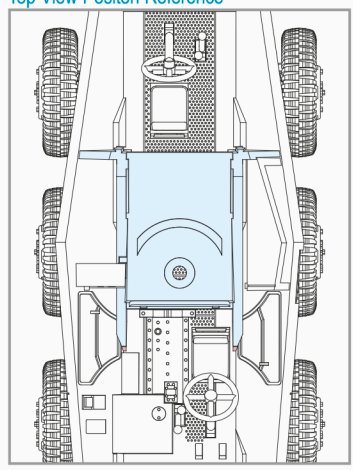

15

Upper Chassis Assembly

for SdKfz 234/4

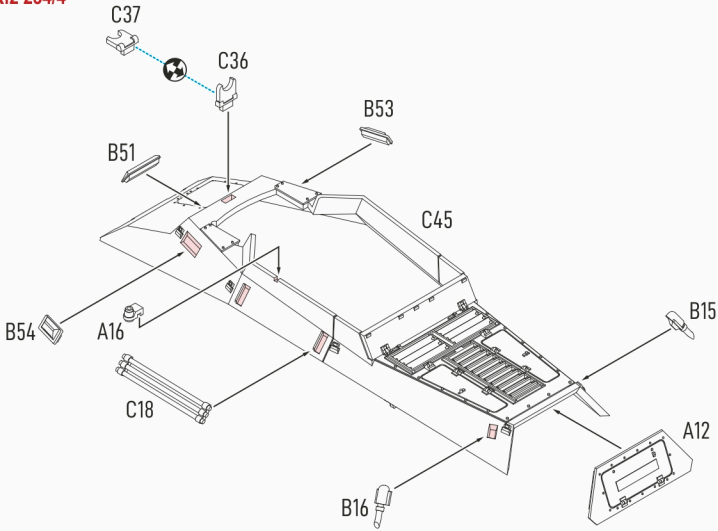

16

Turret Assembly

for SdKfz 234/4

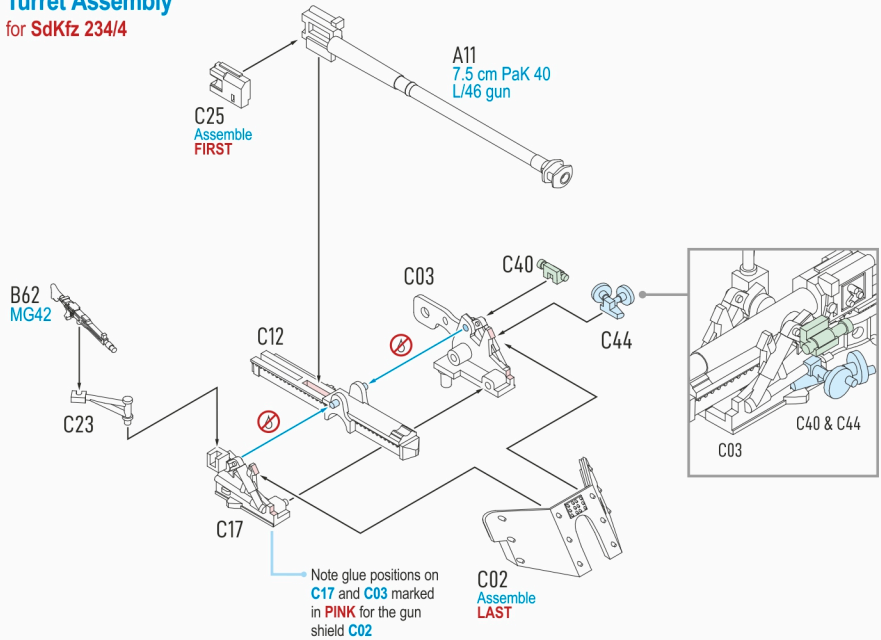

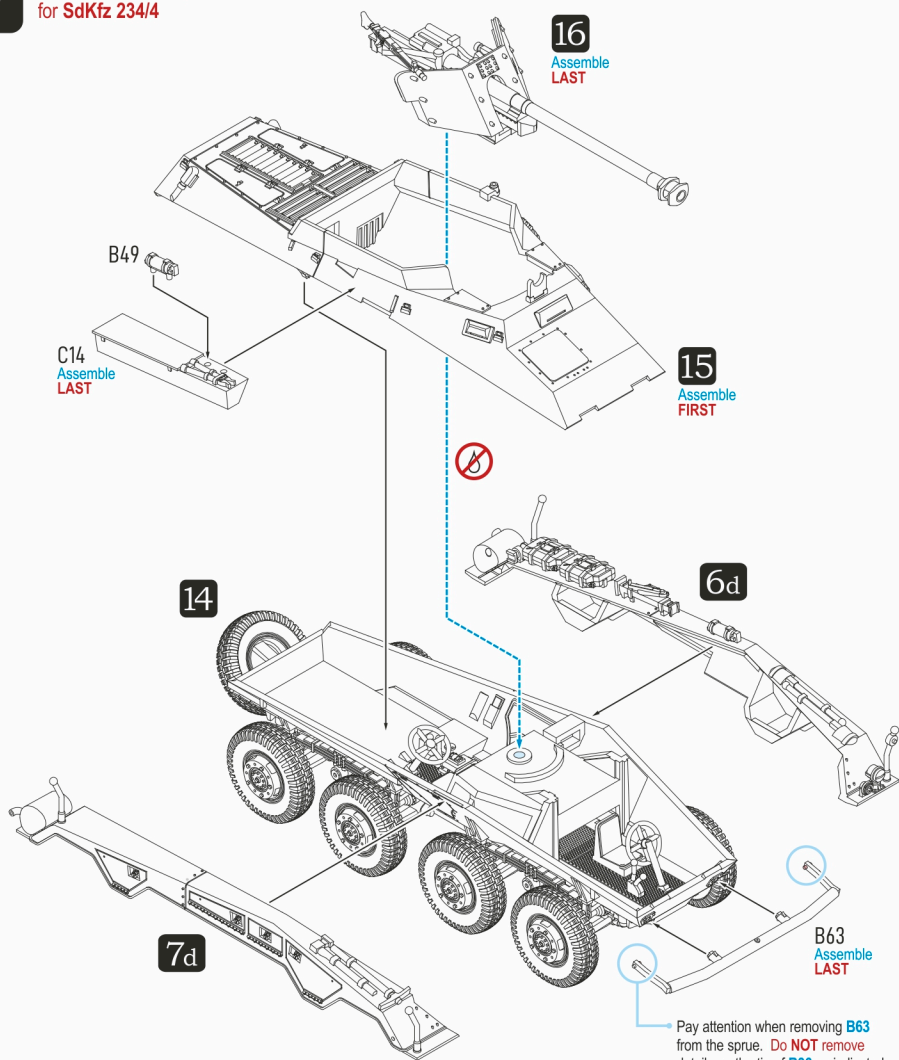

The **SdKfz 234** (Sonderkraftfahrzeug 234, Special Purpose Vehicle 234), was a family of armoured cars designed and built in Germany during World War II. The vehicles were lightly armoured, armed with a 20, 50 or 75mm main gun, and powered by a Tatra V12 diesel engine. There were **four main variants**:

- 234/1** Equipped with a 2cm KwK 38 L/55 autocannon, one 7.92mm MG42 machine gun. This design featured an open-topped turret. Around **200** were produced.
- 234/2** Equipped with a 5cm KwK 39 L/60 gun, one MG42. Employed a fully enclosed turret originally designed for the VK1602 Leopard light tank. The turret front was protected by 30mm (1.2") armour at an angle of 20° from the vertical. The sides and rear had 10mm armour set at 25°, and the top plate was 10mm (0.39") armour. The gun mantlet was rounded and was 40mm to 100mm (1.6" to 3.9") thick. **101** built between September 1943 and September 1944.
- 234/3** Equipped with a 7.5cm K51 L/24 gun in open-topped superstructure replacing the turret. **88** built between June and December 1944.
- 234/4** Equipped with a 7.5cm PaK 40 L/46 gun in open-topped superstructure replacing the turret. **89** built between December 1944 and March 1945.