

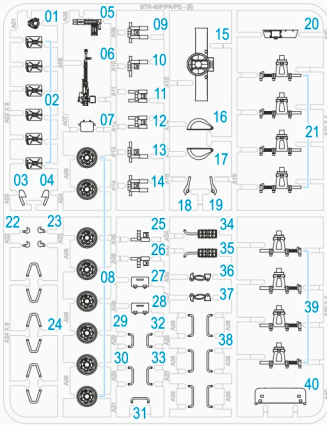

Product Code: 280122
220703-1

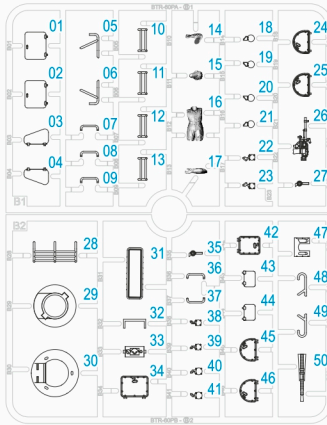

A



B

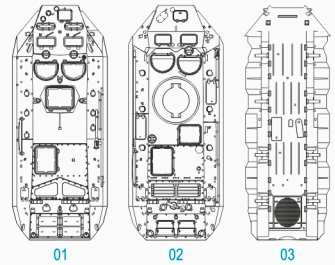

01

02

03

H

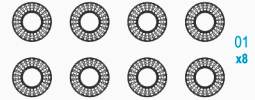

01
x8

R



CAUTION

- When you use glue or paint, do not use near a naked flame, and use in a well-ventilated area.
- When assembling this kit, tools including knives are used. Extra care should be taken to avoid personal injury.
- Keep out of reach of small children.

Read carefully and fully understand the instructions before commencing assembly. Model supplied unpainted. Bases, scenery, glue and paint not included. Meaning of symbols used:



Choices



Optional



No glue



Drill hole



Bend



Cut or trim with care



Please use **ABS Plastic Cement** for assembly.

WARNING

- THIS IS NOT A TOY
- INTENDED FOR COLLECTORS OF AGE 14 AND ABOVE
- CONTAINS SMALL PARTS AND POINTED COMPONENTS
- NOT SUITABLE FOR CHILDREN UNDER 6 YEARS OLD
- MODEL MAY VARY FROM IMAGE ON BOX
- READY TO ASSEMBLE PRECISION MODEL KIT

1

Lower Hull Assembly

Right Side

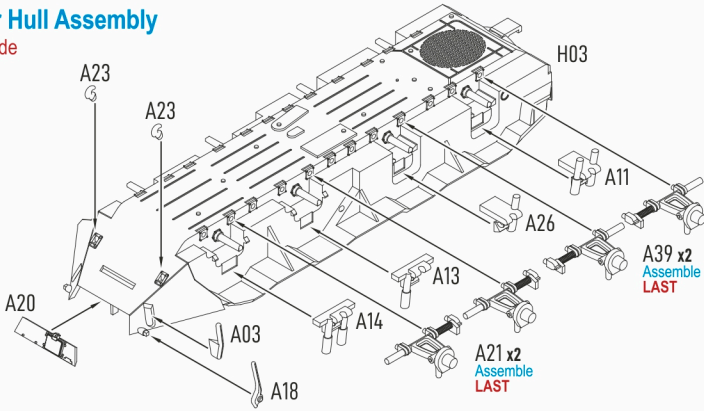

2

Lower Hull Assembly

Left Side

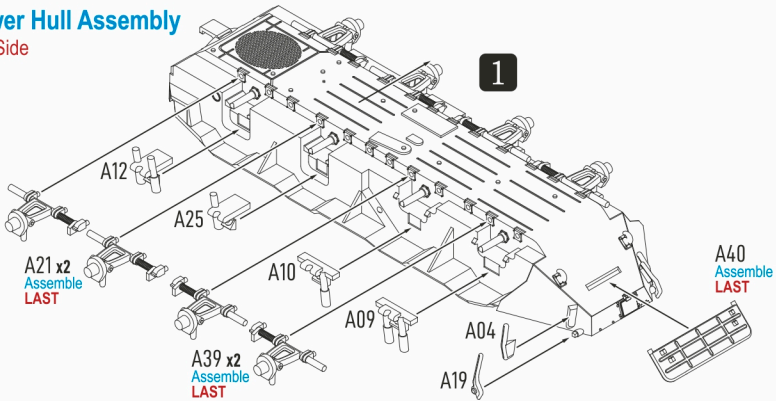

3

Lower Hull Assembly

Rear & Road Wheels

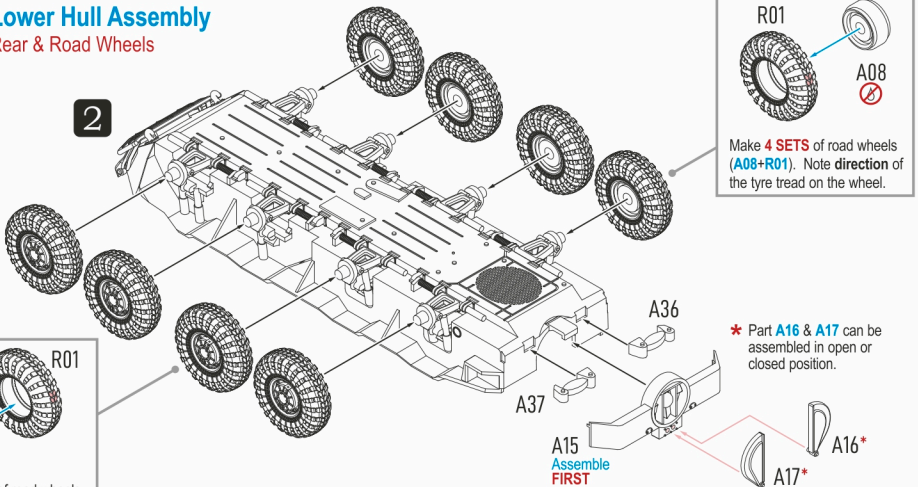

R01

A08

Make 4 SETS of road wheels (A08+R01). Note direction of the tyre tread on the wheel.

R01

A08

Make 4 SETS of road wheels (A08+R01). Note direction of the tyre tread on the wheel.

* Part A16 & A17 can be assembled in open or closed position.

Continue with Step 4a for BTR-60PA or skip to Step 5a for BTR-60PB 

4a

Upper Hull Assembly - BTR-60PA

Left Side

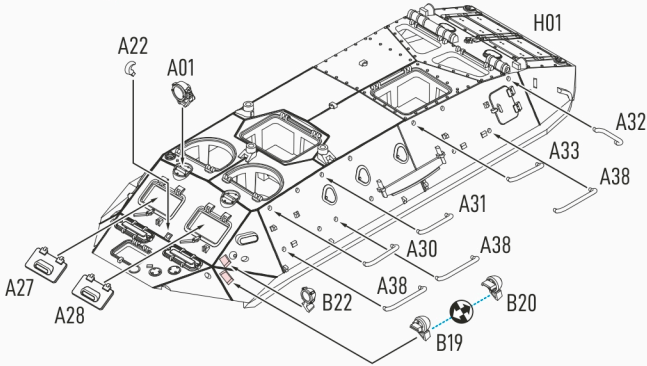

4b

Upper Hull Assembly - BTR-60PA

Left Side

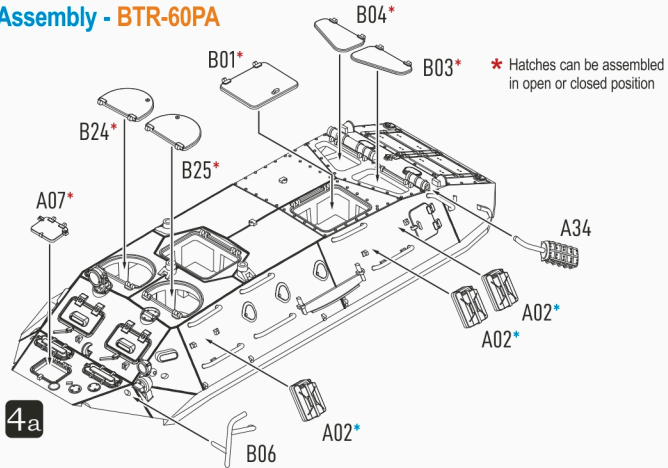

* Optional

4c

Upper Hull Assembly - BTR-60PA

Right Side

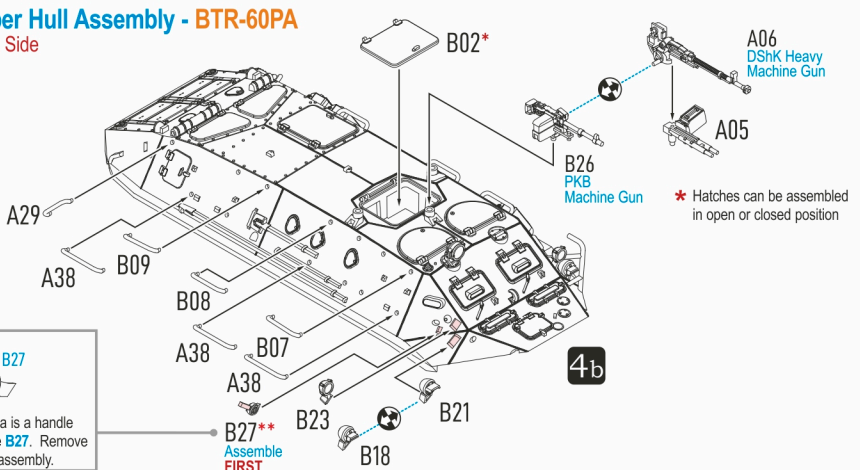

****** The highlight area is a handle to help assemble **B27**. Remove the handle after assembly.

B27 Assemble FIRST**

4d

Upper Hull Assembly - BTR-60PA

Right Side

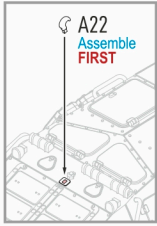

B10 / B11
B12 / B13
Assemble 4 using
the highlighted
holes as guides

4c

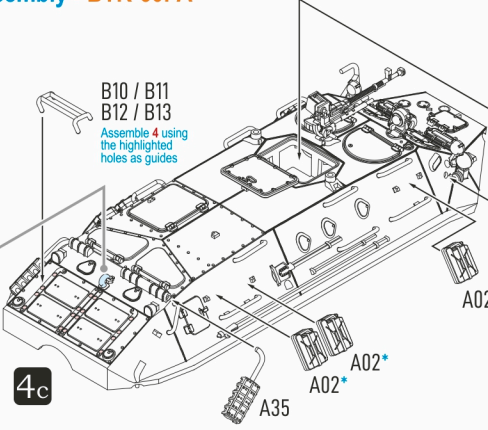

* Optional

4e

Final Assembly - BTR-60PA

Underside

3 Assemble
LAST

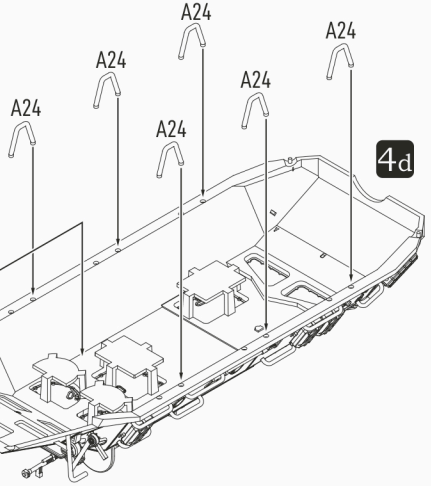
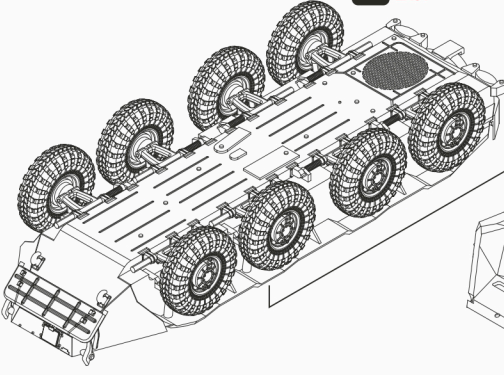

5a

Turret Assembly - BTR-60PB

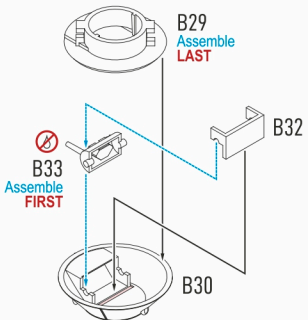

5b

Turret Assembly - BTR-60PB

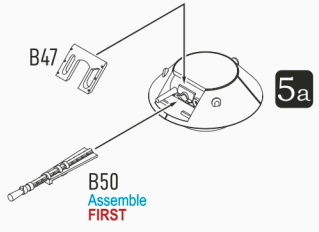

5c

Upper Hull Assembly - BTR-60PB

Left Side

* Trim off the highlighted area if A01 is to be used

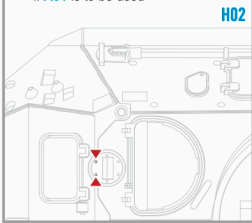

H02

A01*
Optional

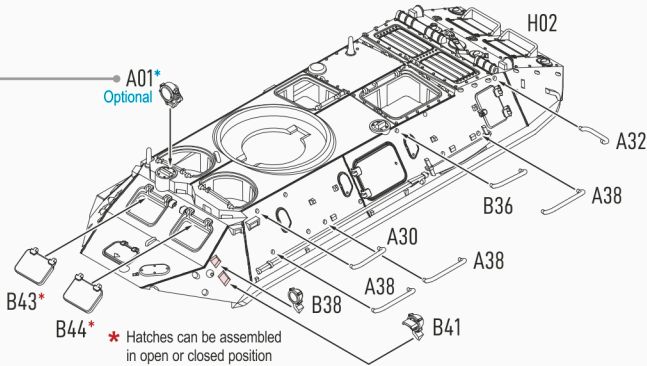

* Hatches can be assembled in open or closed position

5d

Upper Hull Assembly - BTR-60PB

Left Side

* Hatches can be assembled in open or closed position

5c

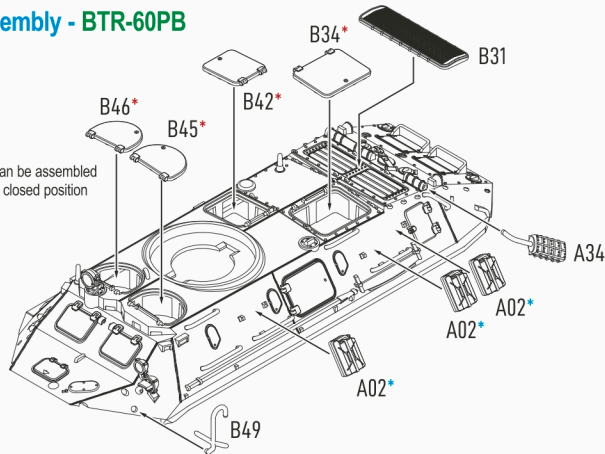

* Optional

5e

Upper Hull Assembly - BTR-60PB

Right Side

5b

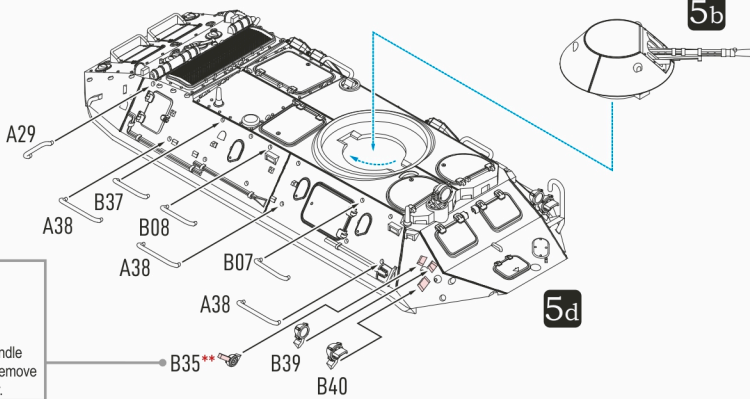
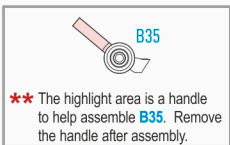

5f Upper Hull Assembly - BTR-60PB

Right Side

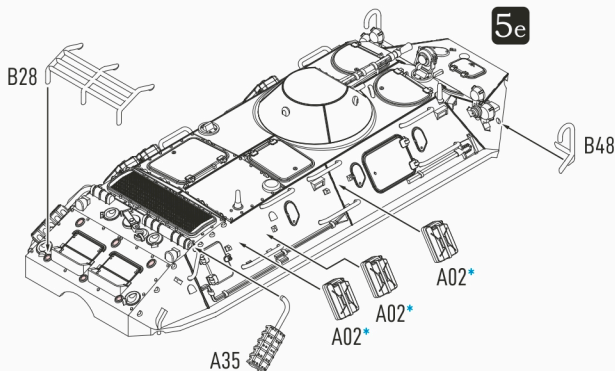

* Optional

5g Final Assembly - BTR-60PB

Underside

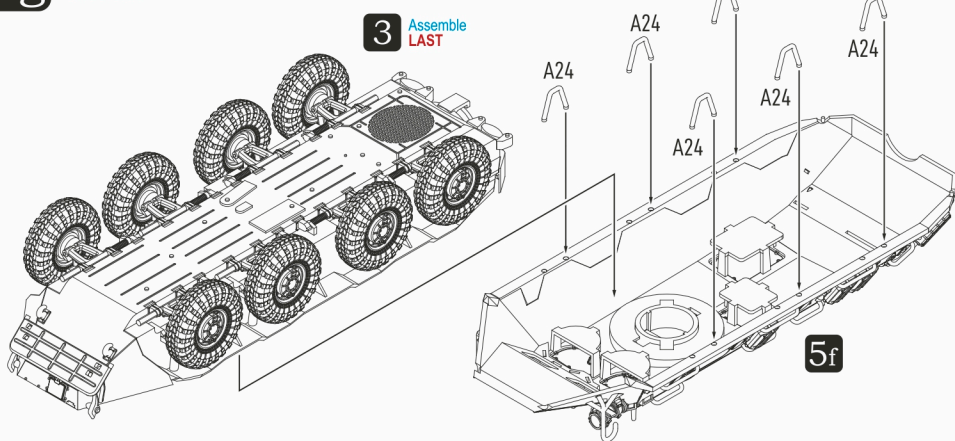

If you enjoyed building this **Soviet BTR-60PA / BTR-60PB APC**, you may also want to explore our other plastic kits. **Rubicon Models** offers an expanding range of **Cold War**-era kits for your selection; please visit our regional webstores for more product information.

We also invite you to visit our **Facebook Community Page**, where members share their Rubicon Models painting and modelling tips, as well as their latest work!



280120
Soviet T-54-2 / T-54-3
T-54A / T-54B MBT

www.facebook.com/rubiconmodels

www.facebook.com/groups/rubiconmodelscommunity

www.youtube.com/rubiconmodels

Rubicon Models
Regional
Webstores



www.rubiconmodelsasia.com



www.rubiconmodels.co.uk



www.rubiconmodelsusa.com