

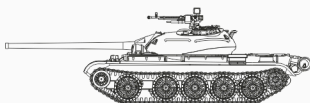

Product Code: 280120  
220615-1



T-54-2 MBT



T-54-3 MBT



T-54A MBT



T-54B MBT (Early Production)



T-54B MBT (Mid Production)



T-54B MBT (Late Production)

### ! READ THIS FIRST BEFORE ASSEMBLY STARTS...

Please study the instruction thoroughly **before** the actual assembly. This kit gives you the option to build either a **T-54-2**, **T-54-3**, **T-54A**, or **T-54B** main battle tank within a certain production period. It is good practice to **test fit** all parts and study all build options **before** gluing them together. This will save you time and frustrations!

A sprue layout diagram is located at the back of this instruction booklet. Some (optional) parts require you to drill holes, please make sure to locate the correct one. To ensure best fitting, please use drill bit of 1.3mm (0.05") in diameter.



CAUTION

- When you use glue or paint, do not use near a naked flame, and use in a well-ventilated area.
- When assembling this kit, tools including knives are used. Extra care should be taken to avoid personal injury.
- Keep out of reach of small children.

Read carefully and fully understand the instructions before commencing assembly. Model supplied unpainted. Bases, scenery, glue and paint not included. Legend used:



Choices



Optional



No glue



Drill hole



Bend



Cut or trim  
with care

 Please use **ABS Plastic Cement** for our plastic kits.

### WARNING

- THIS IS NOT A TOY
- INTENDED FOR COLLECTORS OF AGE 14 AND ABOVE
- CONTAINS SMALL PARTS AND POINTED COMPONENTS
- NOT SUITABLE FOR CHILDREN UNDER 6 YEARS OLD
- MODEL MAY VARY FROM IMAGE ON BOX
- READY TO ASSEMBLE PRECISION MODEL KIT

# 1 Tank Crew

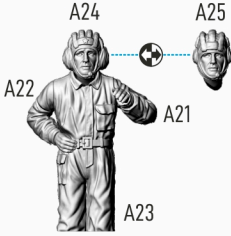

# 2 Lower Hull

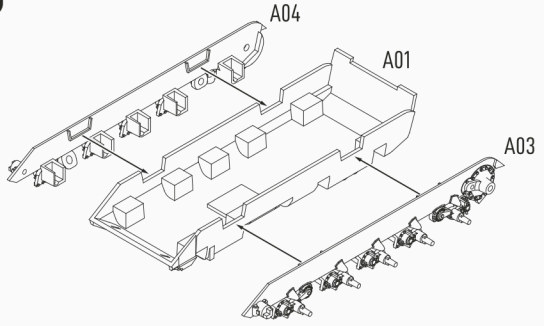

# 3a Sprocket & Road Wheels

for T-54-2 / T-54-3 / T-54A

Make 2 Sets of Road Wheels

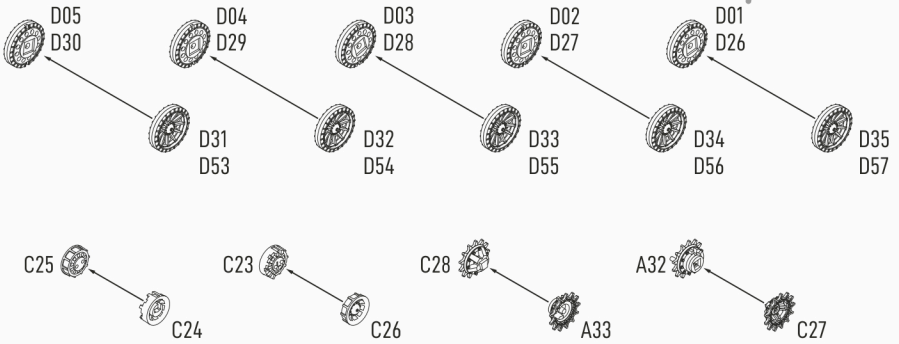

# 3b Sprocket & Road Wheels

for T-54-B

Make 2 Sets of Road Wheels

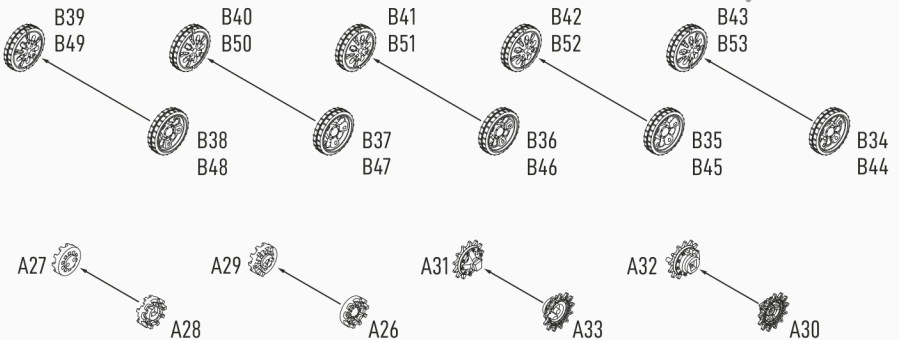

## 4 Hull Underside

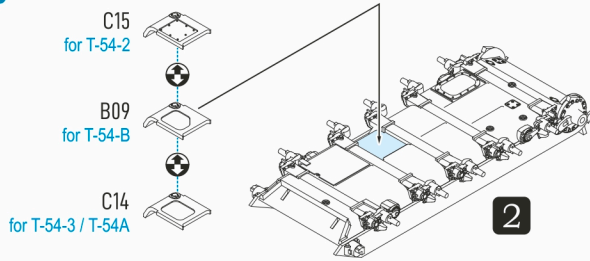

## 5 Lower Hull Sprocket & Wheels

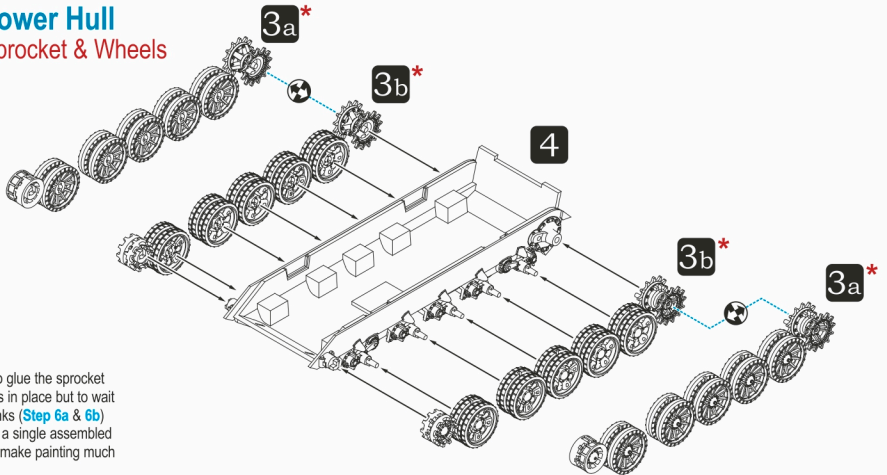

\* It is best **NOT** to glue the sprocket and road wheels in place but to wait until the track links (**Step 6a & 6b**) are attached as a single assembled piece. This will make painting much more efficient.

## 6a Track Links Assembly Left Side\*

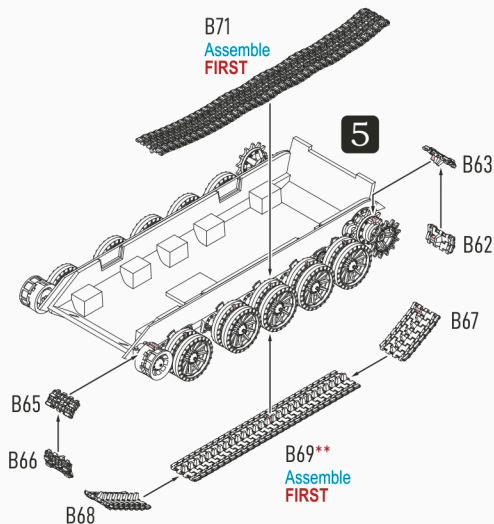

\* The track link parts on the **LEFT** and **RIGHT** side might look similar but are different. **DO NOT** mix them up.

\*\* On all the wheels and track link parts, there are "notches" on them to aid your assembly. Simply apply cement to keep the parts together.

# 6b

## Track Links Assembly Right Side\*

\* The track link parts on the **LEFT** and **RIGHT** side might look similar but are different. **DO NOT** mix them up.

\*\* On both the wheels and track links, there are "notches" for a perfect fit. Simply apply glue to keep the parts together.

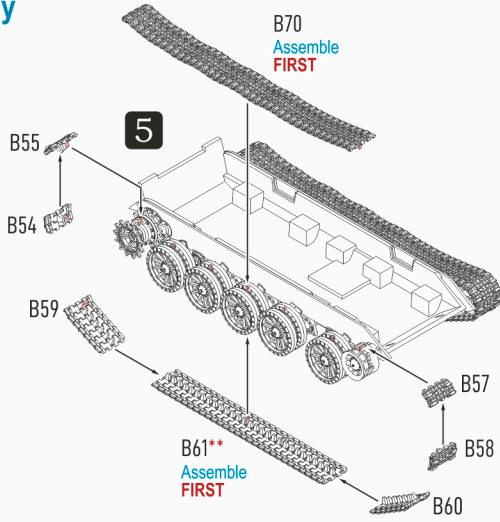

**T-54-2** continue with Step 7a



**T-54A** skip to Step 9a



**T-54-3** skip to Step 8a



**T-54B** skip to Step 10a

# 7a

## Upper Hull for T-54-2 MBT

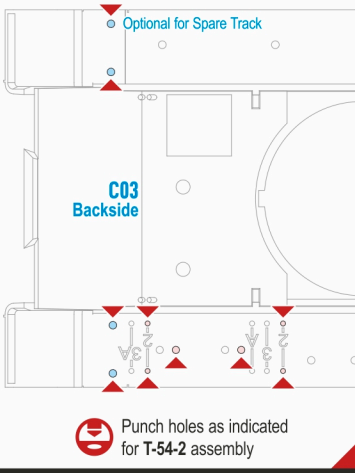

# 7b

## Upper Hull - Right Side for T-54-2 MBT

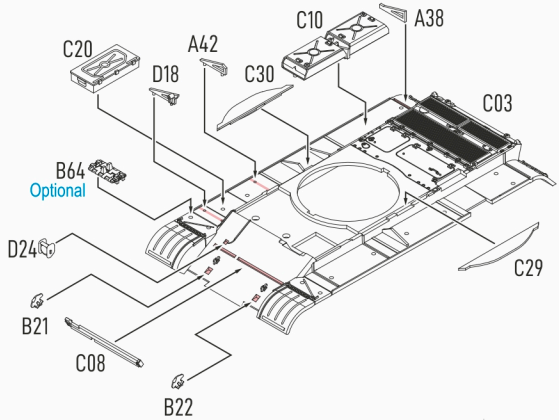

If you enjoyed building the **Soviet T-54 & variants** plastic kit, we invite you to explore our extensive catalogue of **Vietnam War** and **Cold War** vehicles. Our range covers everything from heavy tanks and trucks to light utility vehicles. **Rubicon Models** also has a wide selection of plastic and resin figures specifically designed to complement our vehicle line. Discover our full offerings on our regional webstores.

Please also visit our official **Facebook** page at <https://www.facebook.com/rubiconmodels>

Follow our **Facebook** page to show your support!



280122  
BTR-60PA  
& 60PB APC

# 7c

## Upper Hull - Left Side

for T-54-2 MBT

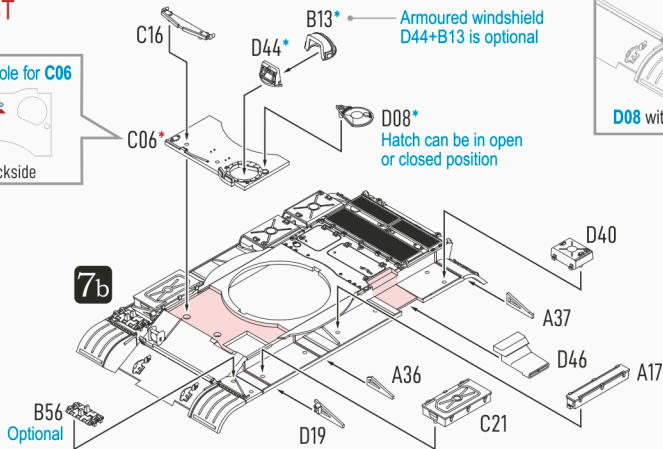

# 7d

## Gun Turret - Front

for T-54-2 MBT

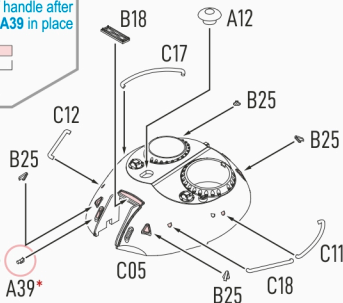

# 7e

## Gun Turret - Rear

for T-54-2 MBT

\* If D44 & B13 are used in Step 7c, then use A20 only. Both parts are optional.

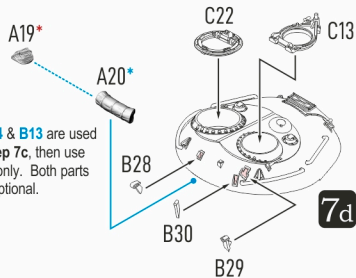

# 7f

## Gun Turret - Final

for T-54-2 MBT

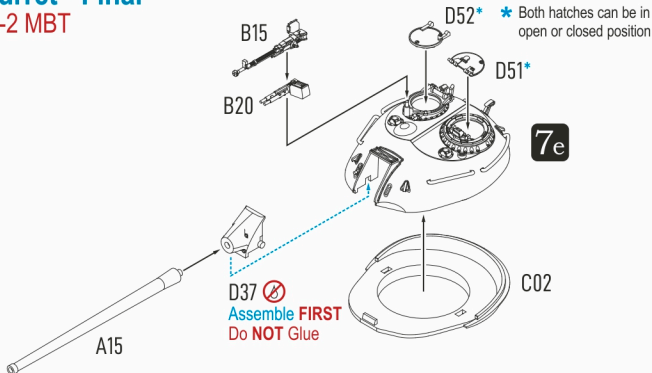

# 7g

## Turret & Hull for T-54-2 MBT

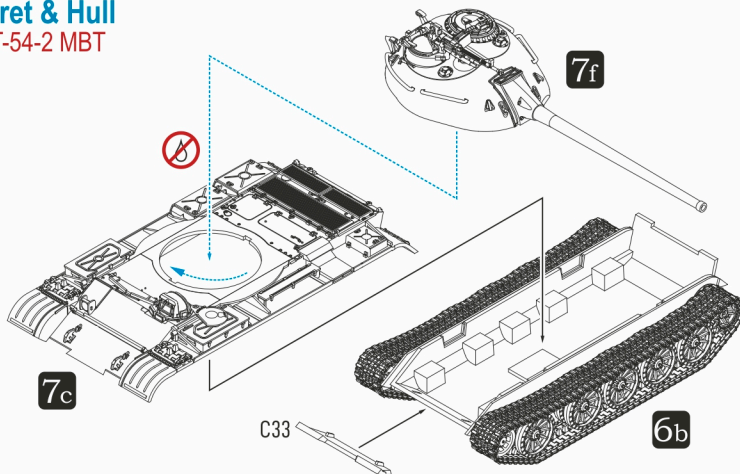

# 7h

## Final Assembly for T-54-2 MBT - Skip to Step 11

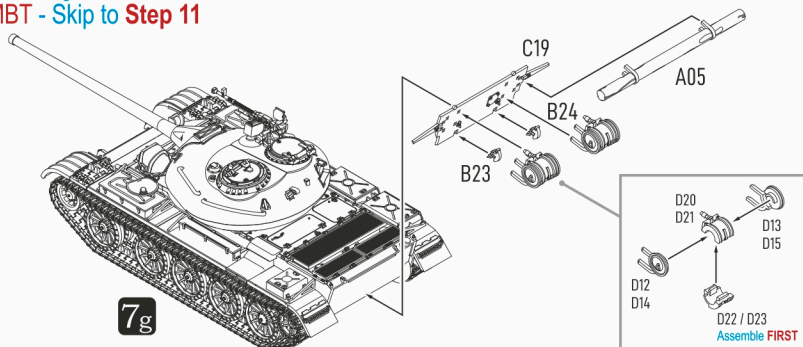

# 8a

## Upper Hull - Right Side for T-54-3 MBT

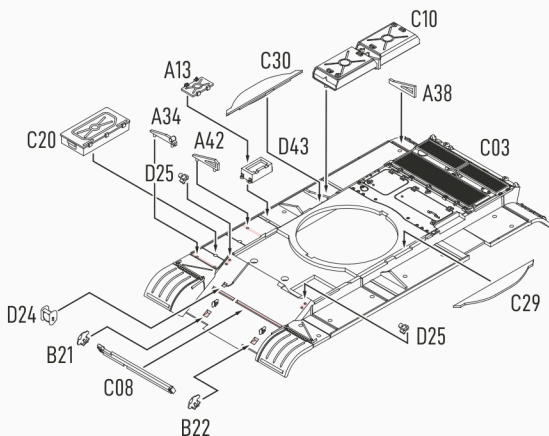
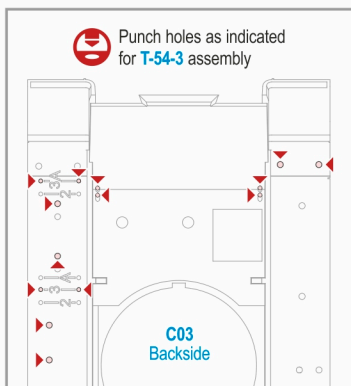

# 8b

## Upper Hull - Left Side for T-54-3 MBT

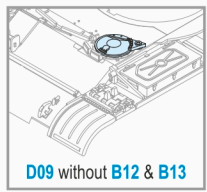
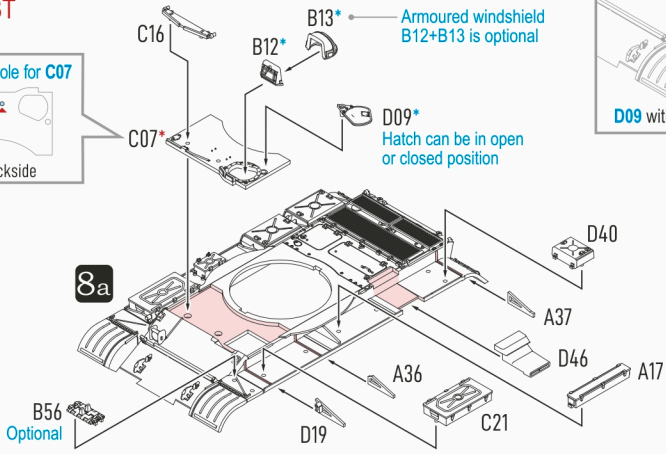

# 8c

## Gun Turret - Front for T-54-3 MBT

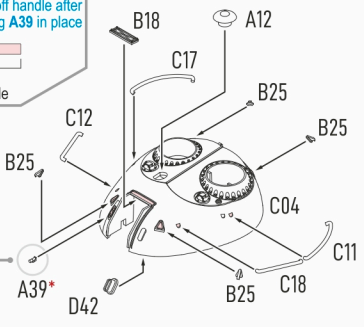

# 8d

## Gun Turret - Rear for T-54-3 MBT

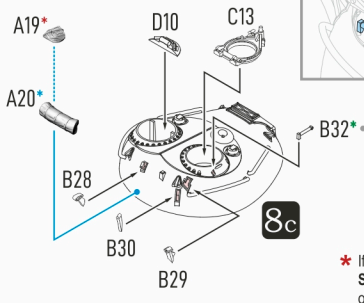
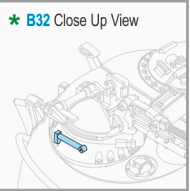

\* If B12 & B13 is used in Step 8b, then use A20 only. Both parts are optional.

# 8e

## Gun Turret - Final for T-54-3 MBT

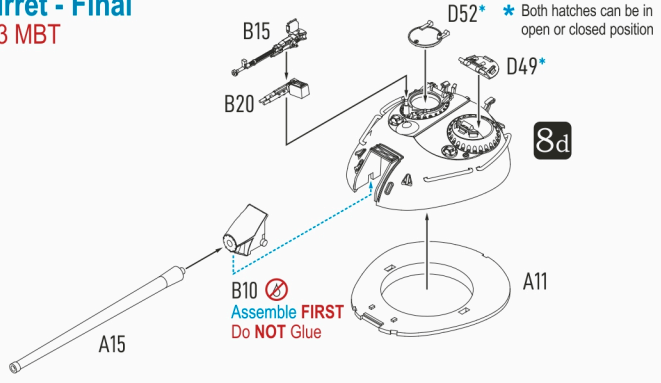

# 8f Turret & Hull for T-54-3 MBT

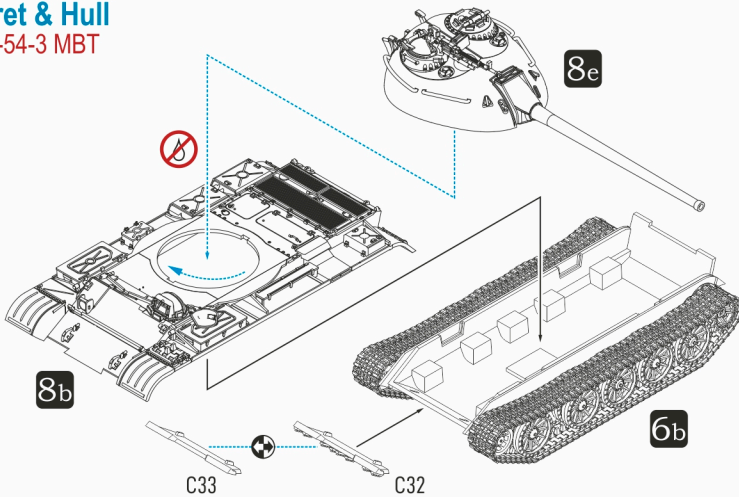

# 8g Final Assembly for T-54-3 MBT - Skip to Step 11

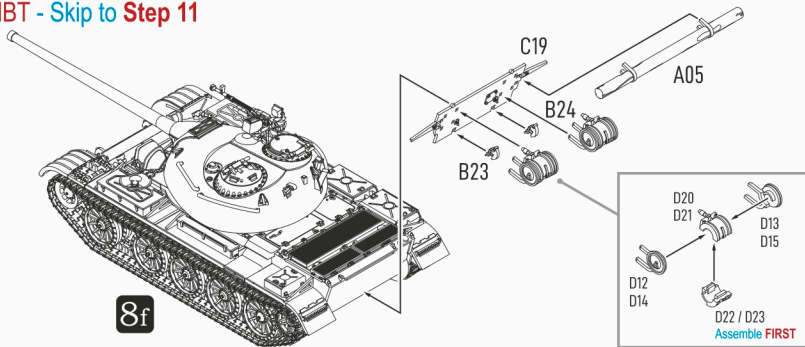

# 9a Upper Hull for T-54A MBT

 Punch holes as indicated  
for T-54A assembly

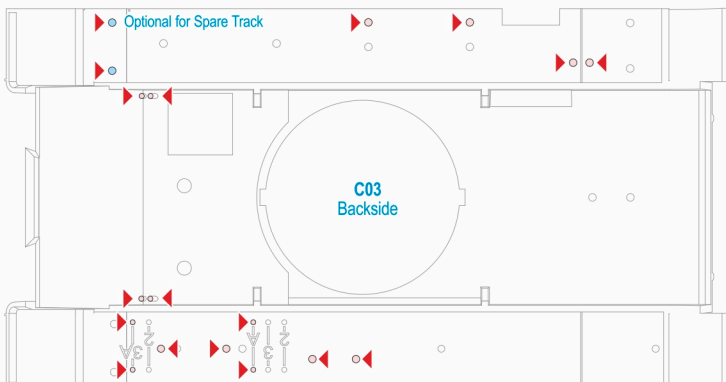

# 9b

## Upper Hull - Right Side for T-54A MBT

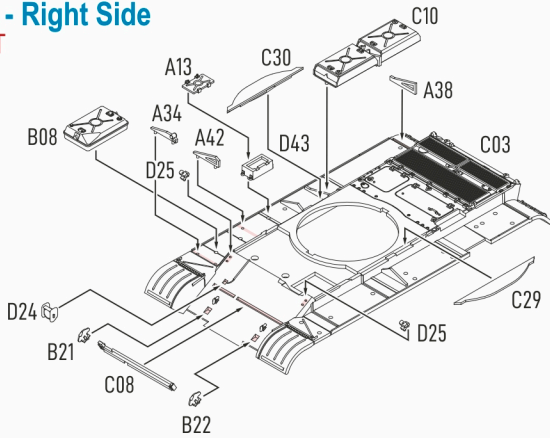

# 9c

## Upper Hull - Left Side for T-54A MBT

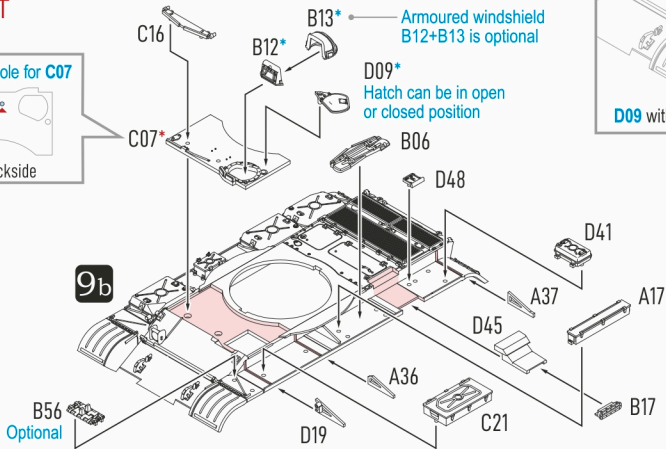

# 9d

## Gun Turret - Front for T-54A MBT

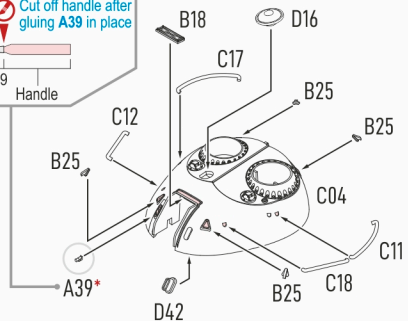

## 9e Gun Turret - Rear for T-54A MBT

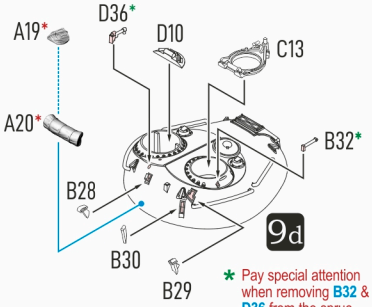

\* Play special attention when removing B32 & D36 from the sprue

\* If B12 & B13 are used in Step 9c, then use A20 only. Both parts are optional.

## 9f Gun Turret - Final for T-54A MBT

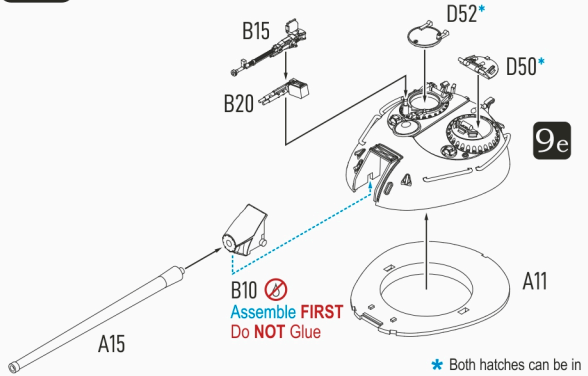

B10 Assemble FIRST  
Do NOT Glue

\* Both hatches can be in open or closed position

## 9g Turret & Hull for T-54A MBT

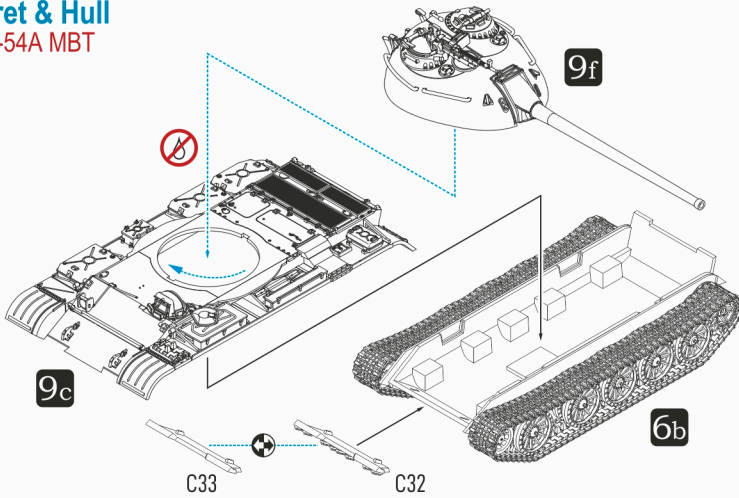

## 9h Final Assembly for T-54A MBT - Skip to Step 11

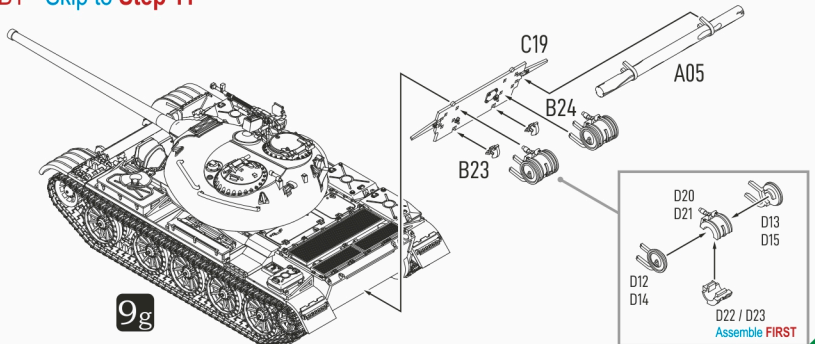

# 10a Upper Hull for T-54B MBT

 Punch holes as indicated  
for T-54B assembly

 Punch holes  
as indicated  
for T-54B  
assembly

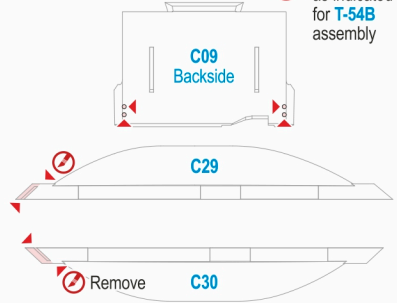
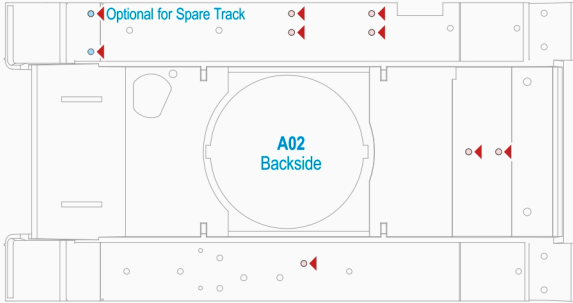

# 10b Upper Hull - Right Side for T-54B MBT

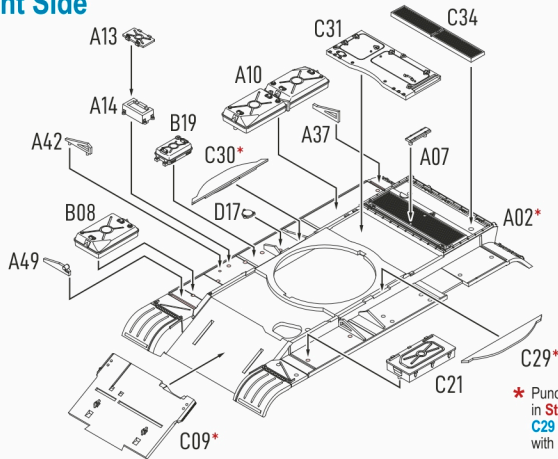

\* Punch holes as required  
in Step 10a and make sure  
C29 and C30 are trimmed  
with a cutter

# 10c Upper Hull - Left Side for T-54B MBT

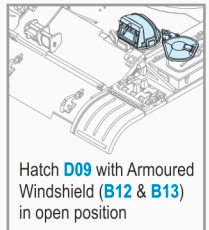
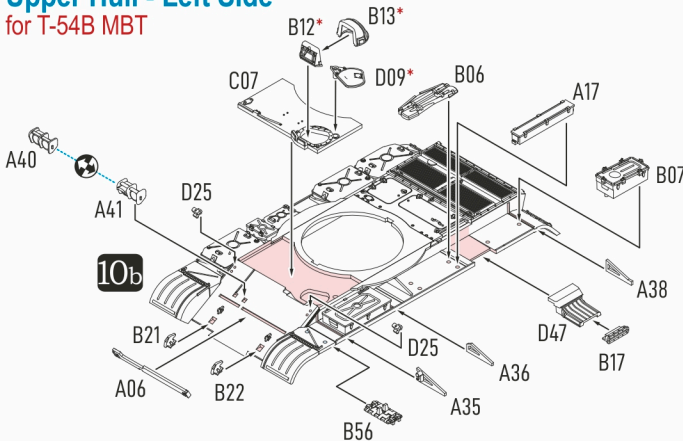

Hatch D09 with Armoured  
Windshield (B12 & B13)  
in open position

# 10d Gun Turret - Front for T-54B MBT

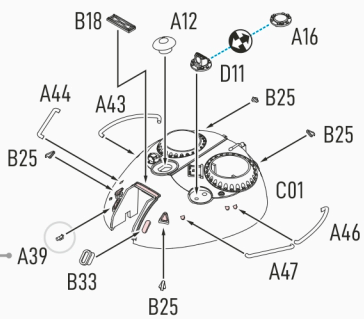

# 10e Gun Turret - Rear for T-54B MBT

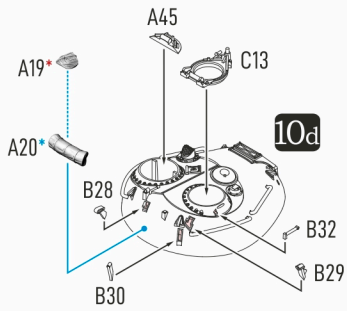

\* If B12 & B13 are used in Step 10c, then use A20 only. Both parts are optional.

# 10f Gun Turret - Hatches & MG for T-54B MBT

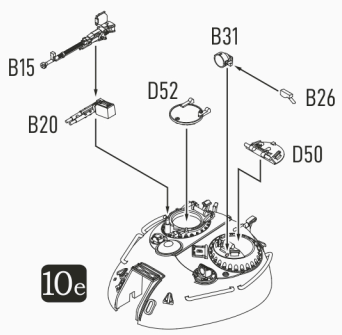

# 10g Gun Turret - Final for T-54B MBT

\* Study the diagram carefully and follow the instruction for **early**, **mid** or **late** production variant assembly

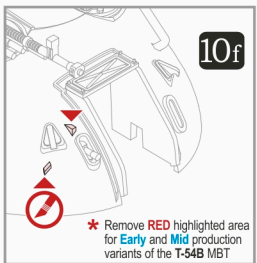
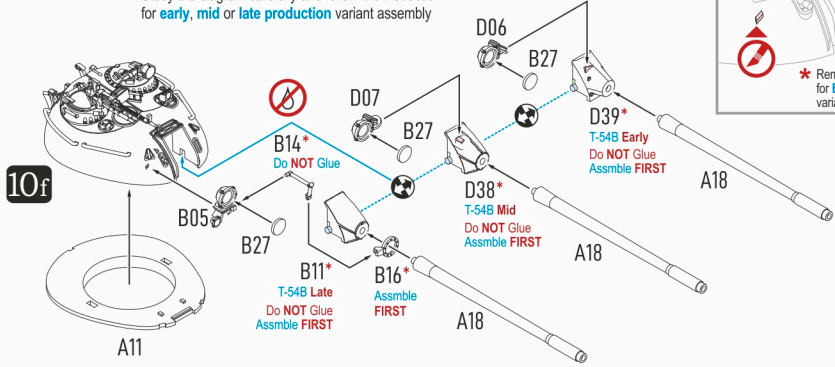



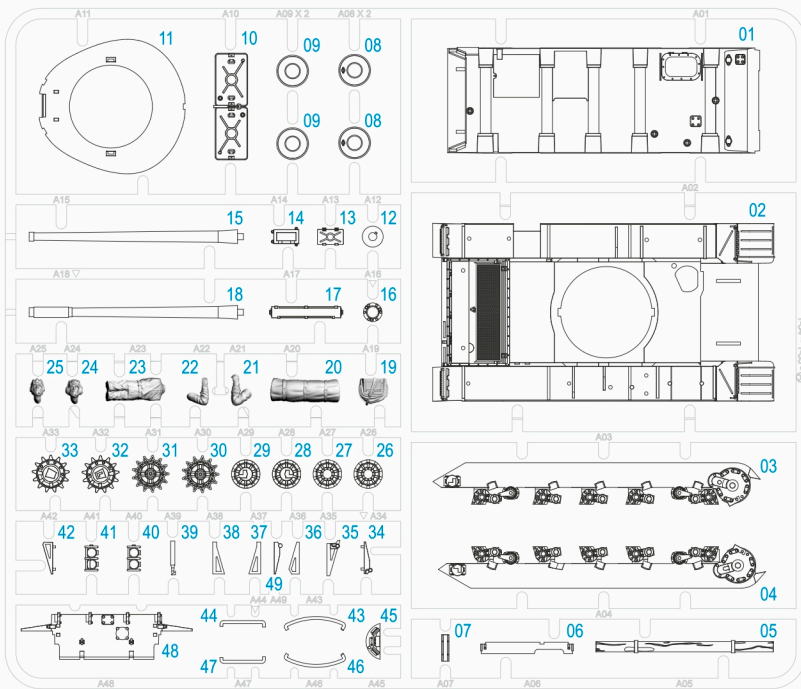

**A**

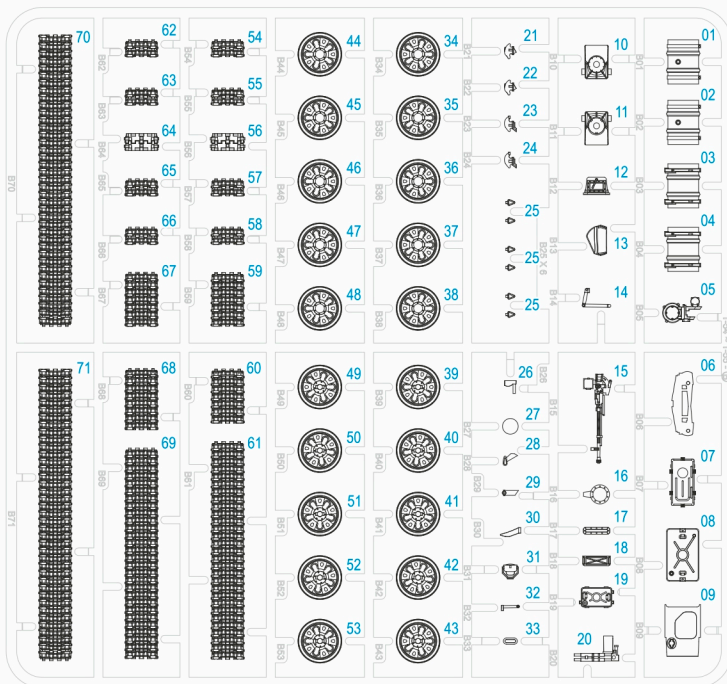

**B**

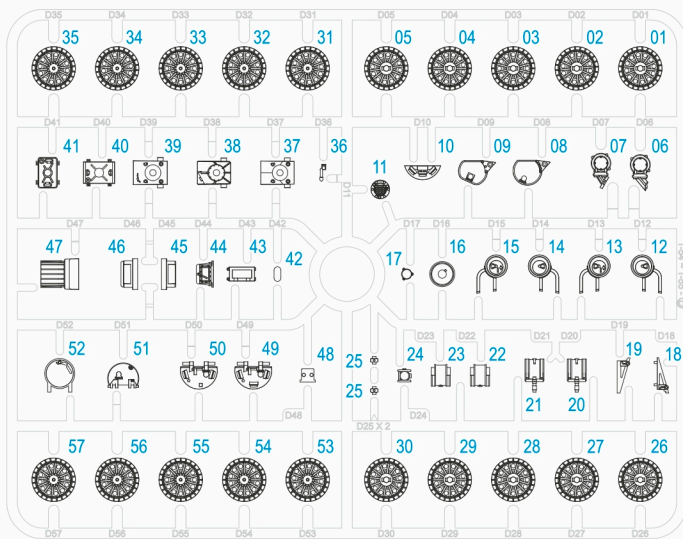
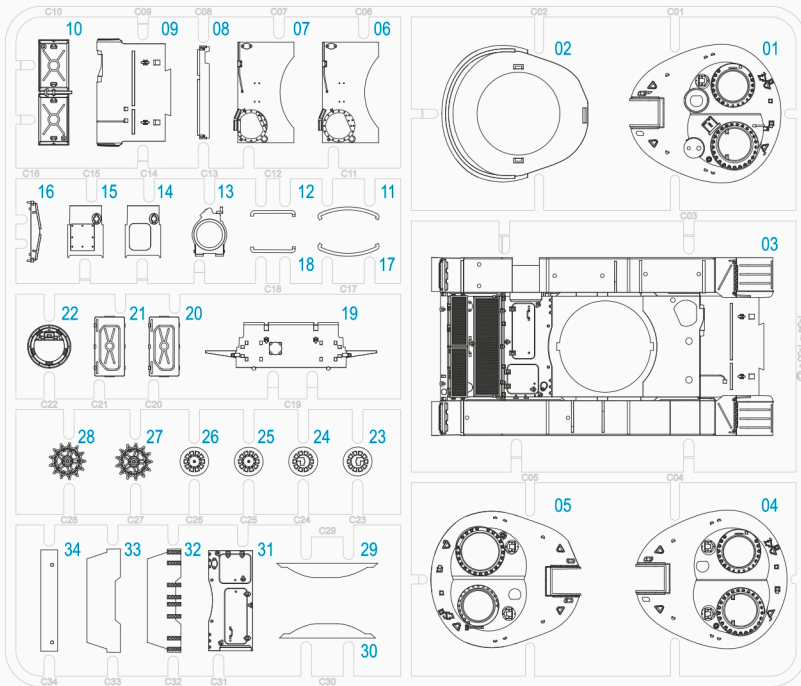



280121 Soviet T-55 & T-55A (early production) MBT



280122 Soviet BTR-60PA / 60PB APC



280137 Chinese Type 63 APC



280132 Soviet ZIS-150 & ZIL-164 4x2 Truck



281001 Viet Cong Fighters with Command



281003 People's Army of Vietnam (NVA) with Command



281002 US Marines with Command



281004 US Army

OFFICIAL WEBSTORES



[www.rubiconmodelsasia.com](http://www.rubiconmodelsasia.com)



[www.rubiconmodels.co.uk](http://www.rubiconmodels.co.uk)



[www.rubiconmodelsusa.com](http://www.rubiconmodelsusa.com)