

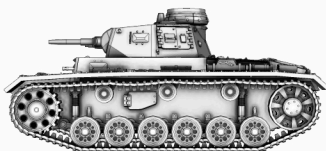

Product Code: **280091**
 250604-2



Panzer III Ausf E



Panzer III Ausf F

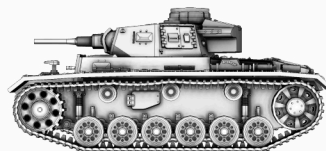

Panzer III Ausf G



READ THIS FIRST BEFORE ASSEMBLY STARTS...

Please study the instruction thoroughly **before** actual assembly. This kit enables you to build either a **Panzer III Ausf E, Ausf F or Ausf G** medium command tank. It is good practice to **test fit** all parts and study all build options **before** gluing them together. This will save you time and frustrations!

A sprue layout guide is located at the back of this instruction booklet. Some (optional) parts require drilling holes in the parts they are being placed. To ensure best fitting, please use drill bit of 1.3mm (0.05") in diameter.



ASIA PACIFIC

www.rubiconmodelsasia.com



UNITED KINGDOM

www.rubiconmodels.co.uk



UNITED STATES

www.rubiconmodelsusa.com



CAUTION

- When you use glue or paint, do not use near a naked flame, and use in a well-ventilated area.
- When assembling this kit, tools including knives are used. Extra care should be taken to avoid personal injury.
- Keep out of reach of small children.

Read carefully and fully understand the instructions before commencing assembly. Model supplied unpainted. Bases, scenery, glue and paint not included. Meaning of symbols used:



Choices



Optional



No glue



Drill hole



Bend



Cut or trim
with care

 Please use **ABS Plastic Cement** for assembly.

WARNING

- THIS IS NOT A TOY
- INTENDED FOR COLLECTORS OF AGE 14 AND ABOVE
- CONTAINS SMALL PARTS AND POINTED COMPONENTS
- NOT SUITABLE FOR CHILDREN UNDER 6 YEARS OLD
- MODEL MAY VARY FROM IMAGE ON BOX
- READY TO ASSEMBLE PRECISION MODEL KIT

READ THIS FIRST BEFORE ASSEMBLY STARTS... IMPORTANT!

Please study this instruction booklet thoroughly **before** actual assembly. This kit offers you a choice to build a **Panzer III Ausf E, Ausf F, or Ausf G** medium tank. Furthermore, some variants might have additional build options as well. Please research and decide which variant you wanted to build before proceeding further.

This instruction is divided into several sections, each with a different colour code to help navigating through various build choices, as follow:

- | | | | | | |
|------------------|-------------------------------|----|------------------|-------------------------------|----|
| Section 1 | Common part assembly | | Section 6 | Panzer III Ausf G, variant #1 | G1 |
| Section 2 | Panzer III Ausf E | E | Section 7 | Panzer III Ausf G, variant #2 | G2 |
| Section 3 | Panzer III Ausf F, variant #1 | F1 | Section 8 | Panzer III Ausf G, variant #3 | G3 |
| Section 4 | Panzer III Ausf F, variant #2 | F2 | Section 9 | Finalising the assembly | |
| Section 5 | Panzer III Ausf F, variant #3 | F3 | | | |

Please pay special attention to these colour codes when you are building your model tank. It is also good practice to **test fit** all parts and study all build options **before** gluing them together. This will save you time and frustrations. Enjoy our kit!



Before assembly starts, please drill holes selectively from the underside of the following parts based on the variant you intended to build.

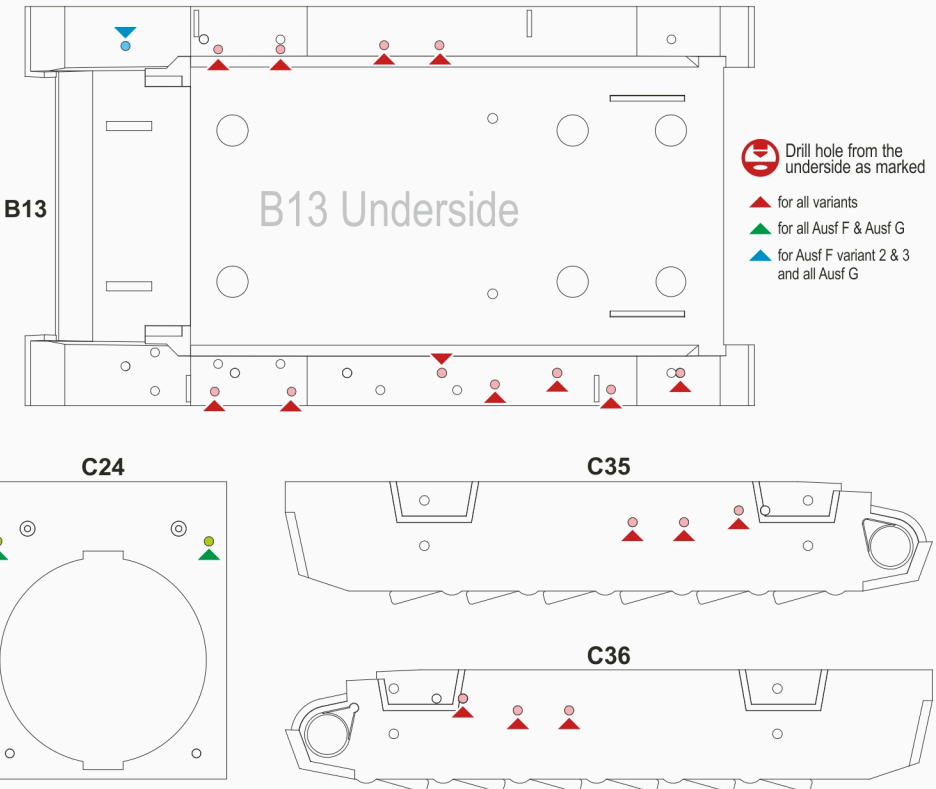

1a

Common Parts

Lower Hull Assembly

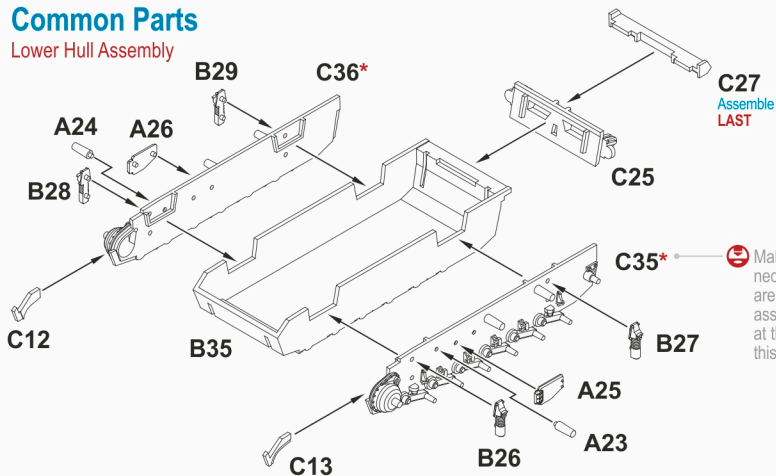

Make sure all necessary holes are drilled before assembly as shown at the beginning of this instruction.

1b

Common Parts

Turret Assembly

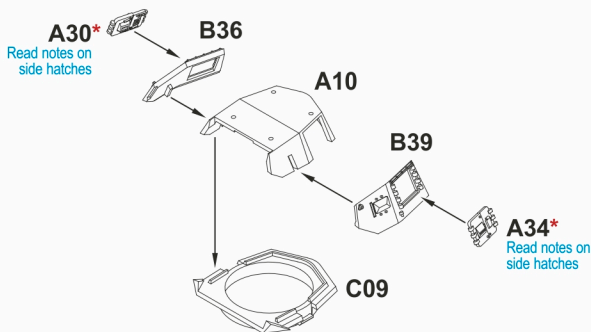

***Turret Side Hatches**

Turret side hatches **A30** and **A34** can be assembled in open position by cutting the part(s) along the debossed line from the underside of the hatch as shown:

1c

Common Parts

Upper Chassis Assembly

The antenna mount can be assembled in either the upright or stowed position.
An optional antenna can also be attached to the mount.

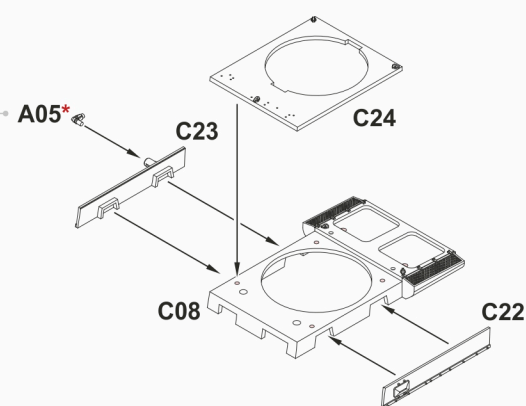

1d**Common Parts**

Hull Top Assembly

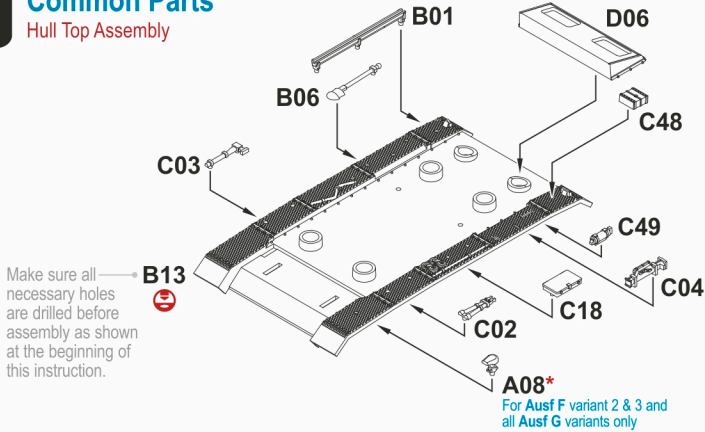
**1e****Common Parts**

Right Track Link & Roadwheels

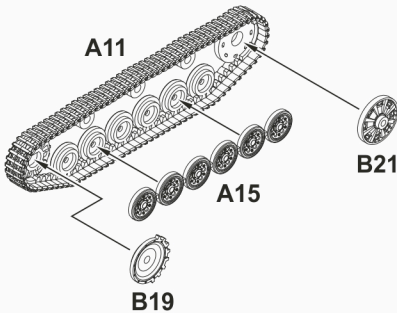
**1f****Common Parts**

Left Track Link & Roadwheels

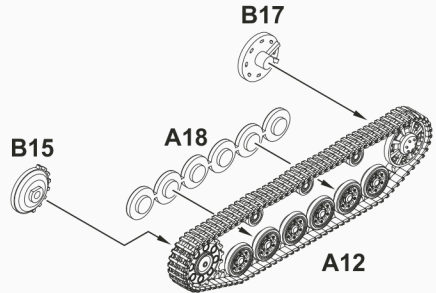
**2a****Panzer III Ausf E Assembly**Skip to **Step 3/4/5** for **Ausf F** variants or **Step 6/7/8** for **Ausf G** variants

Turret Assembly

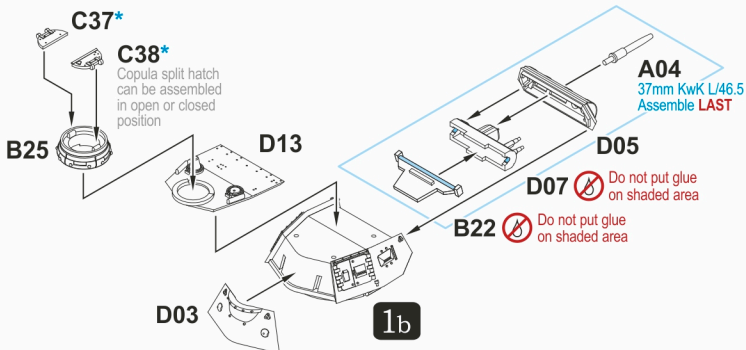
**E**

2b**Panzer III Ausf E**

Upper Chassis Assembly

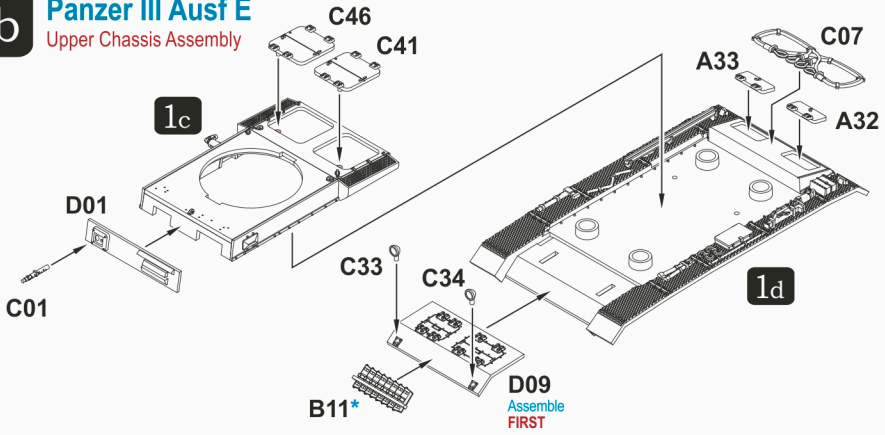

* Optional

2c**Panzer III Ausf E**

Lower Hull Assembly

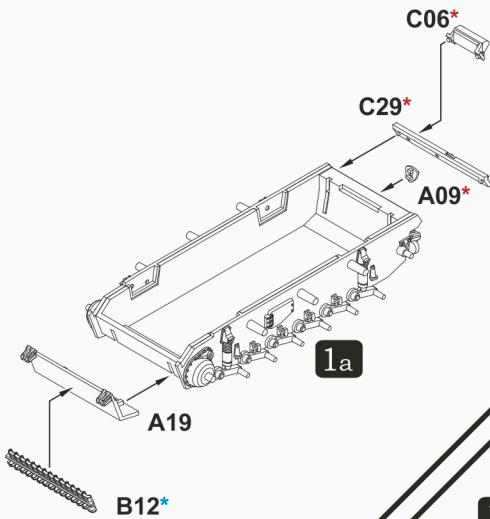

* Optional

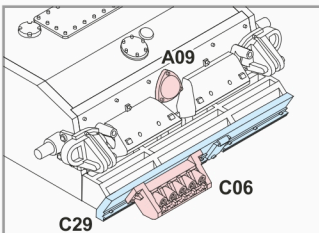

* Underside view of the lower hull assembly showing placement of A09, C06, and C29.

2d**Panzer III Ausf E**

Final Assembly - Skip to Step 9

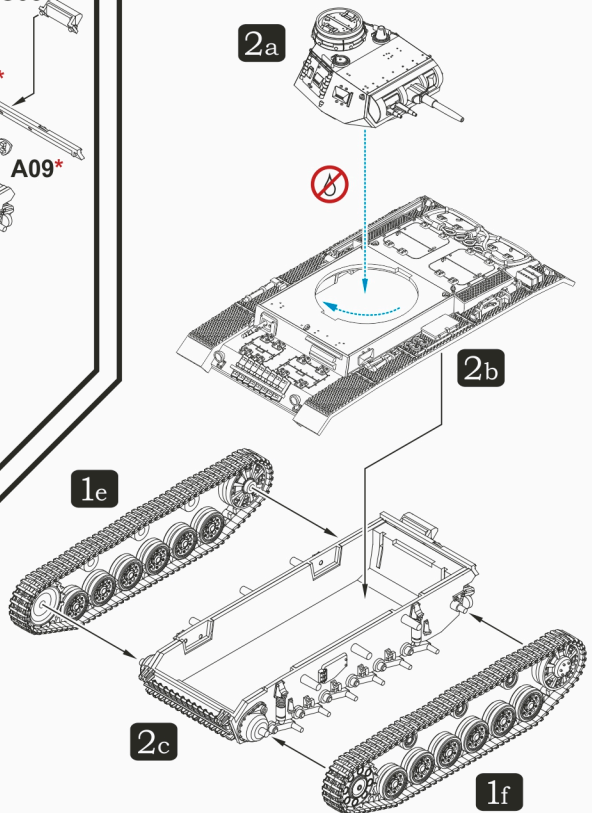

3a

Panzer III Ausf F

Variant #1 - Turret Assembly

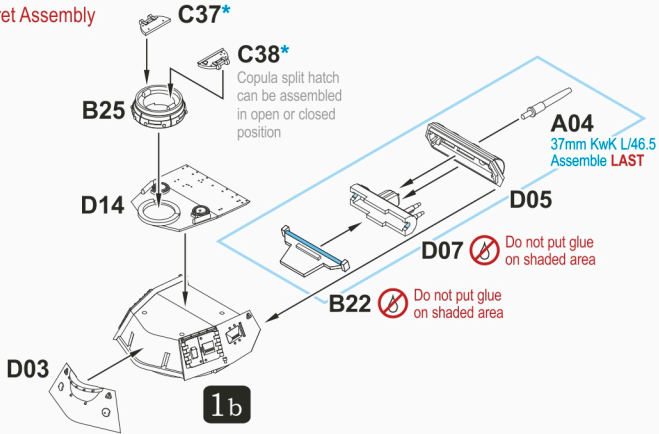

3b

Panzer III Ausf F

Variant #1 - Upper Chassis Assembly

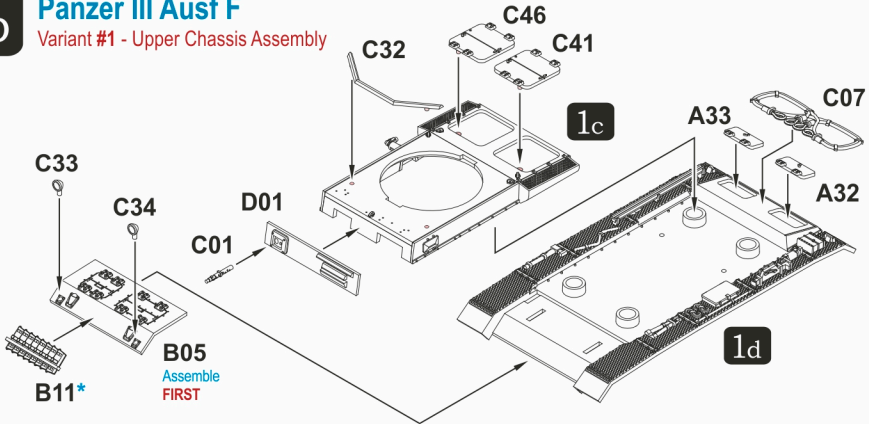

* Optional

3c

Panzer III Ausf F

Variant #1 - Lower Hull Assembly

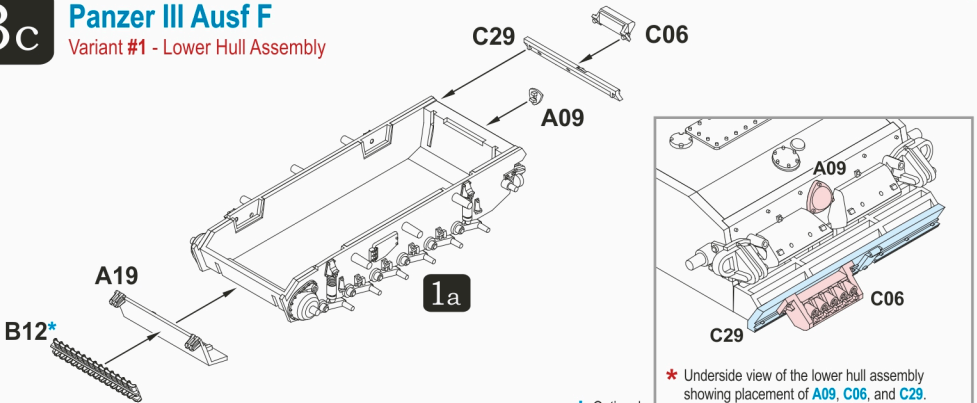

3d

Panzer III Ausf F

Variant #1 - Final Assembly - Skip to Step 9

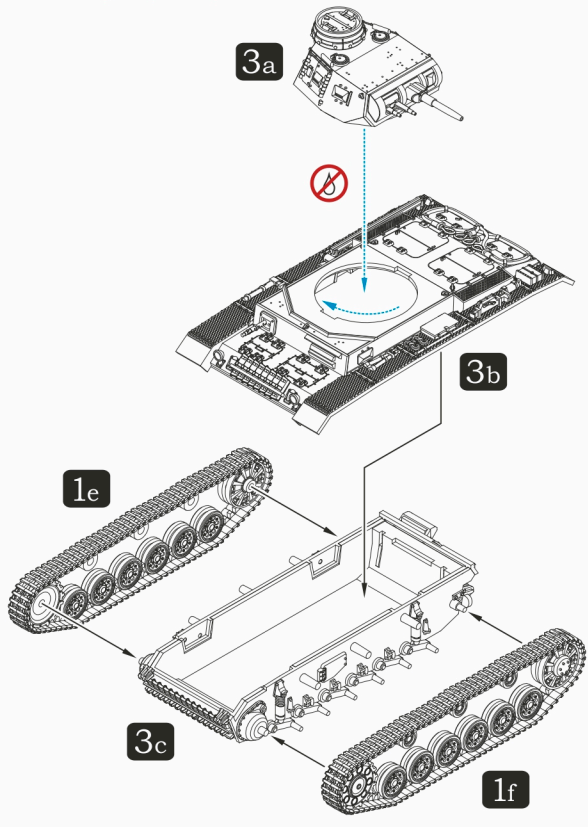

4a

Panzer III Ausf F

Variant #2 - Turret Assembly

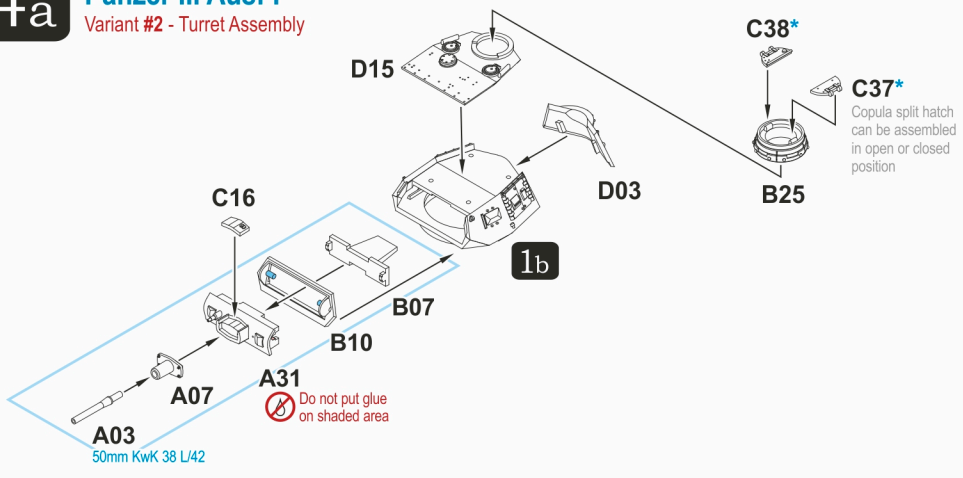

4b

Panzer III Ausf F Variant #2 - Upper Chassis Assembly

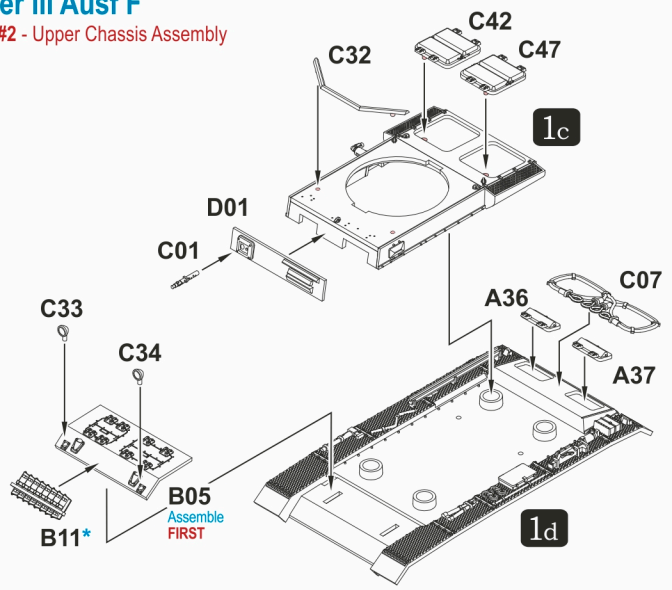

* Optional

4c

Panzer III Ausf F Variant #2 - Lower Hull Assembly

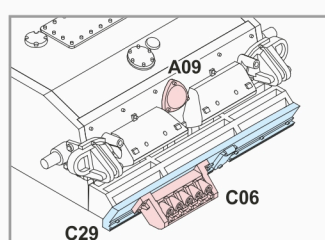
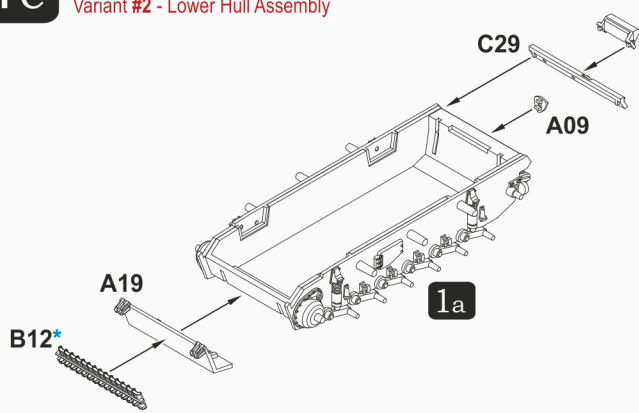

* Underside view of the lower hull assembly showing placement of A09, C06, and C29.

* Optional



BACKGROUND HISTORY - The **Panzerkampfwagen III** (SdKfz 141), commonly known as the **Panzer III**, was a medium tank developed in the 1930s by Germany, and was used extensively in WW2. It was intended to fight other armoured fighting vehicles and serve alongside and support the similar **Panzer IV** which was originally designed for infantry support. However, as the Germans faced the formidable Russian **T-34** tanks, more powerful anti-tank guns were needed, and since the Panzer IV had more development potential with a larger turret ring, it was redesigned to mount the long-barrelled 7.5cm KwK 40 gun. The Panzer III effectively swapped roles with the Panzer IV, as from 1942 the last version of Panzer III mounted the 7.5 cm KwK 37 L/24 that was better suited for infantry support. Production of the Panzer III ceased in 1943. Nevertheless, the Panzer III's capable chassis provided hulls for the **Sturmgeschütz III** assault gun until the end of the war. A total of **5,774** were produced between 1939 and 1943.

...continue on Page 11



Panzer III Ausf E

4d

Panzer III Ausf F

Variant #2 - Final Assembly - Skip to Step 9

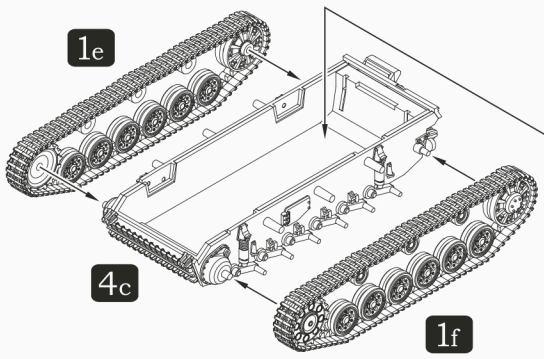

1f

4a

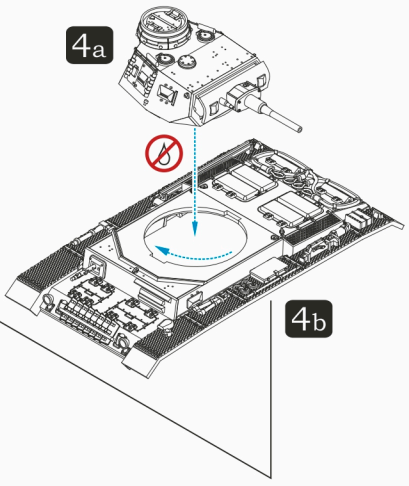

5a

Panzer III Ausf F

Variant #3 - Turret Assembly

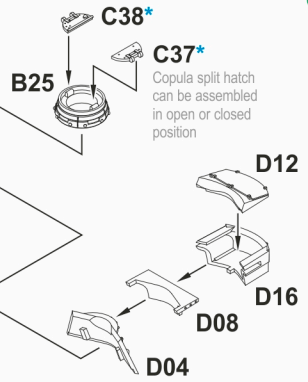
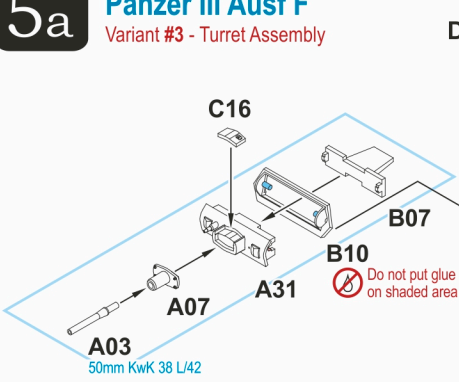

5b

Panzer III Ausf F

Variant #3 - Upper Chassis Assembly

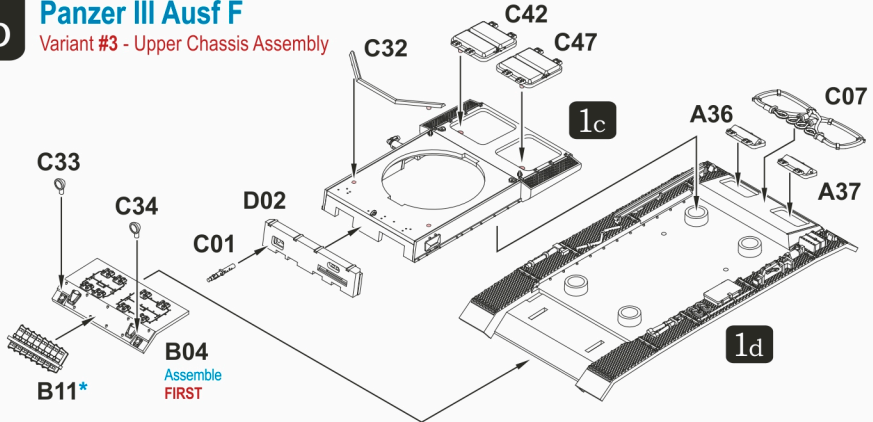

* Optional

5c Panzer III Ausf F

Variant #3 - Lower Hull Assembly

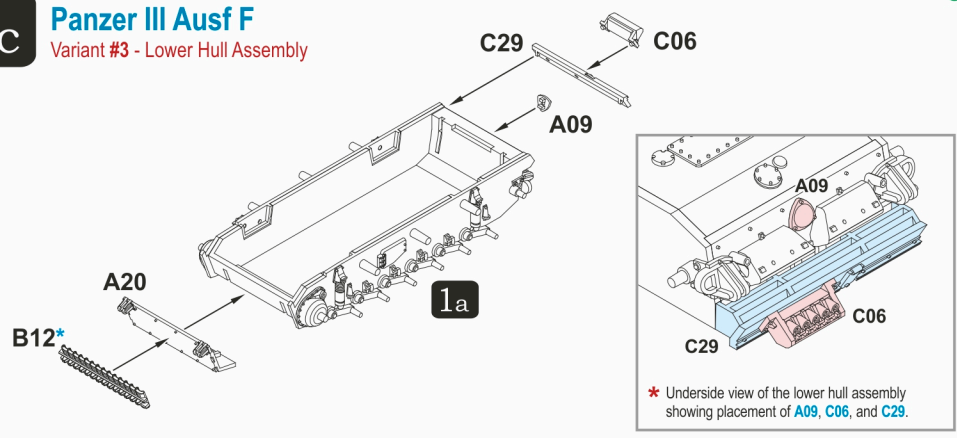

5d Panzer III Ausf F

Variant #3 - Final Assembly - Skip to Step 9

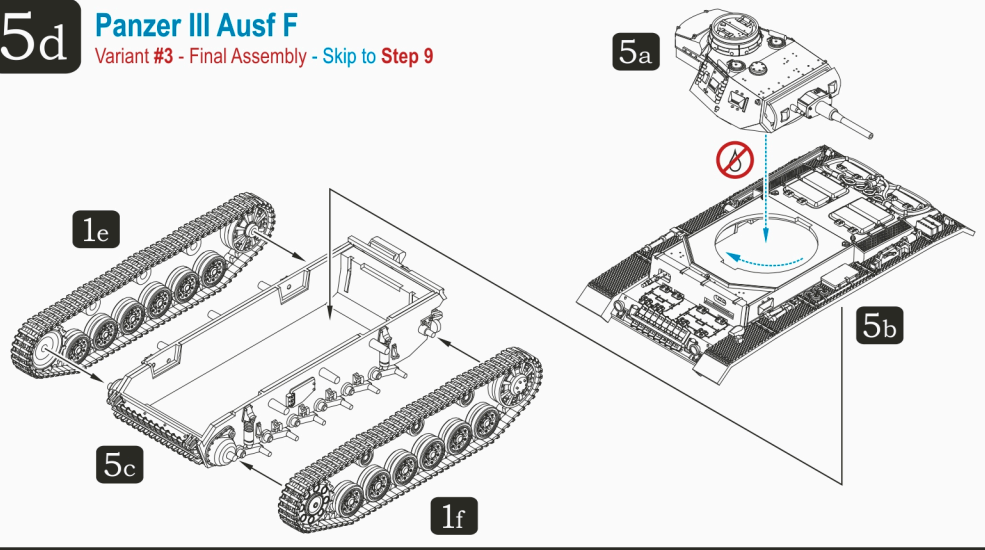

6a Panzer III Ausf G

Variant #1 - Turret Assembly

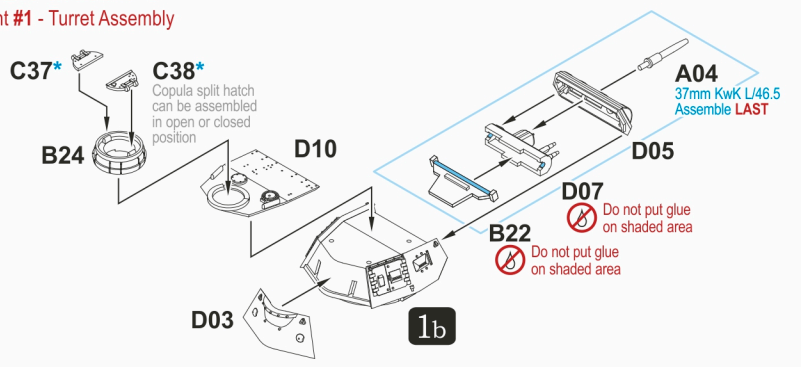

6b

Panzer III Ausf G

Variant #1 - Upper Chassis Assembly

G1

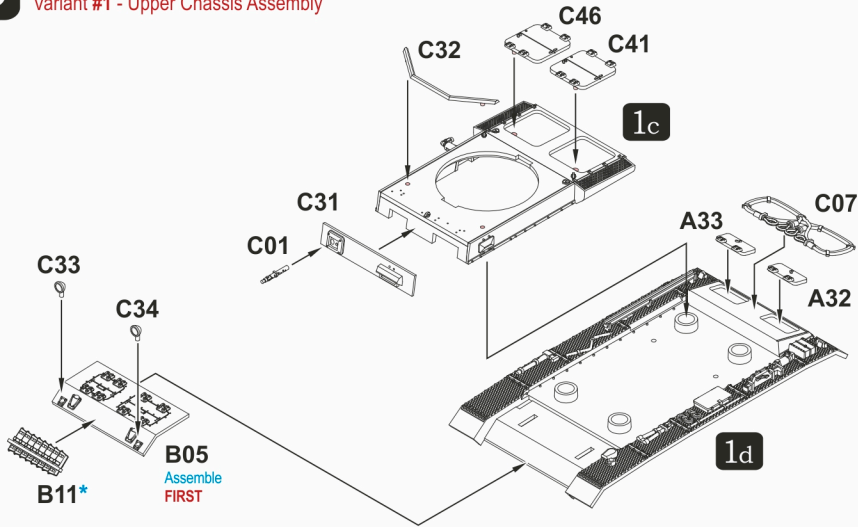

* Optional

6c

Panzer III Ausf G

Variant #1 - Lower Hull Assembly

G1

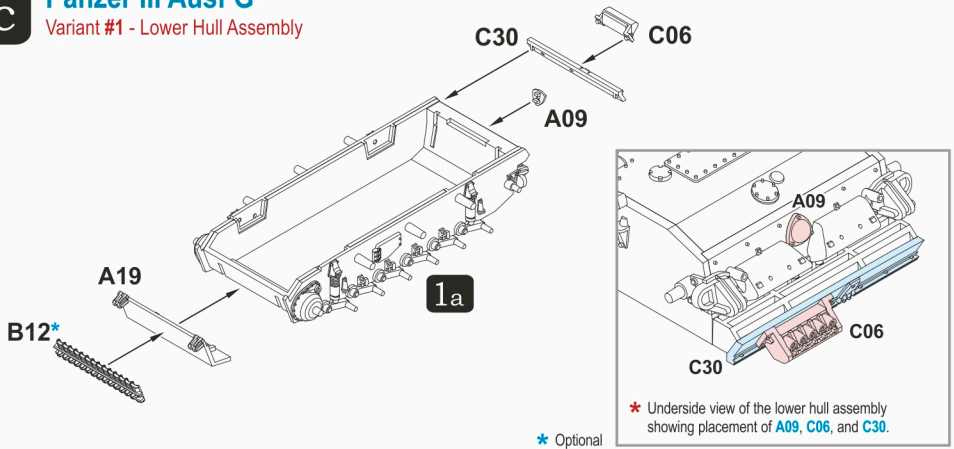

* Optional



BACKGROUND HISTORY (continue from page 8) - The **Ausf E** was the first version of the mass produced Panzer III tanks. The Ausf E, armed with either a 3.7cm KwK 36 L/46.5 or a 5cm KwK 38 L/42 gun, was fitted with torsion bar suspension with six roadwheels on individual swing axles. Three track return rollers were positioned above the road wheels. A few Ausf E saw combat in Poland in 1939.

The factory painted dark grey (dunkelgrau RAL46) and dark brown (dunkelbraun RAL45) camouflage pattern was discontinued by order dated July 31, 1940. They were painted dunkelgrau after that date. Most were used in the invasion of Holland, Belgium and France in May 1940.

The **Ausf F** was initially armed with a 3.7cm KwK 36 L/46.5 gun and later up armoured and fitted with 5cm KwK 38 L/42 gun. Armoured vents were fitted to the turret roof and rear engine deck to enable it to cope with the dust and heat of the North African desert. Paint was dark yellow (dunkelgelb) with extensive usage on the Eastern Front.

The **Ausf G** was produced between March 1940 and early 1941. The first Ausf G tanks were armed with 3.7cm KwK L/46.5 guns. Some took part in the invasion of Holland, Belgium and France in May 1940. After experience during the Battle of France, some were upgraded with a 5cm KwK 38 L/42 gun. They were used on the Eastern Front and in North Africa. Rear turret stowage boxes were sometimes fitted later.

6d

Panzer III Ausf G

Variant #1 - Final Assembly - Skip to Step 9

G1

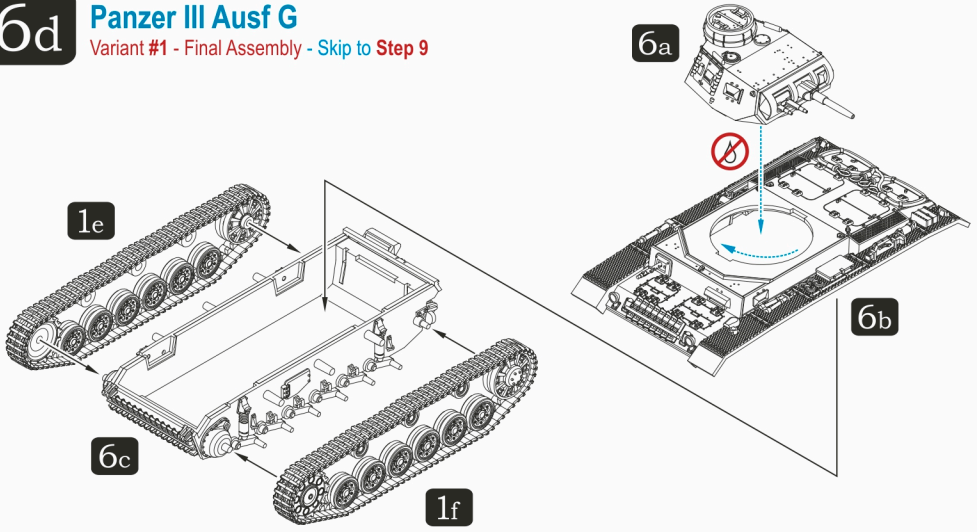

7a

Panzer III Ausf G

Variant #2 - Turret Assembly

G2

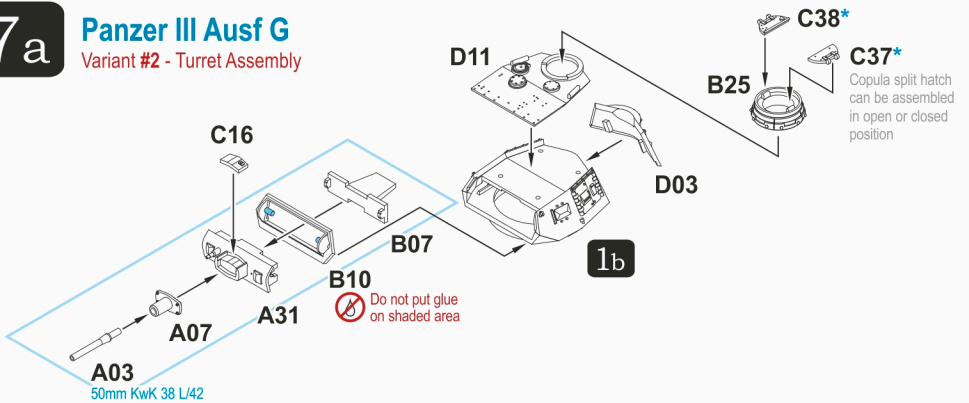

7b

Panzer III Ausf G

Variant #2 - Upper Chassis Assembly

G2

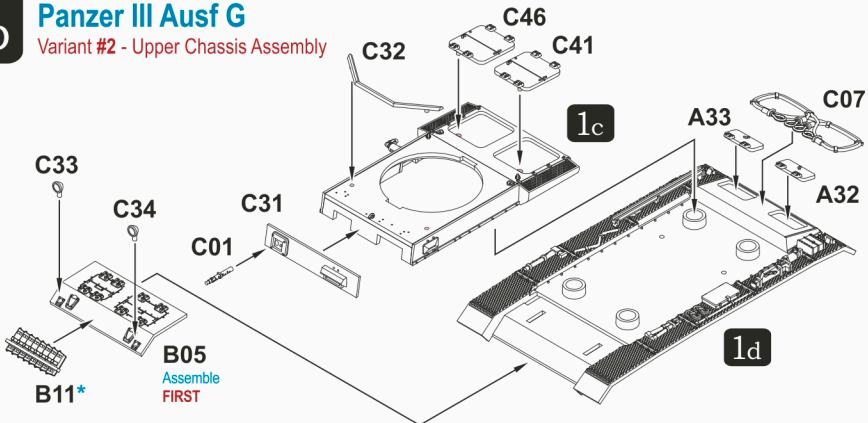

* Optional

7c

Panzer III Ausf G

Variant #2 - Lower Hull Assembly

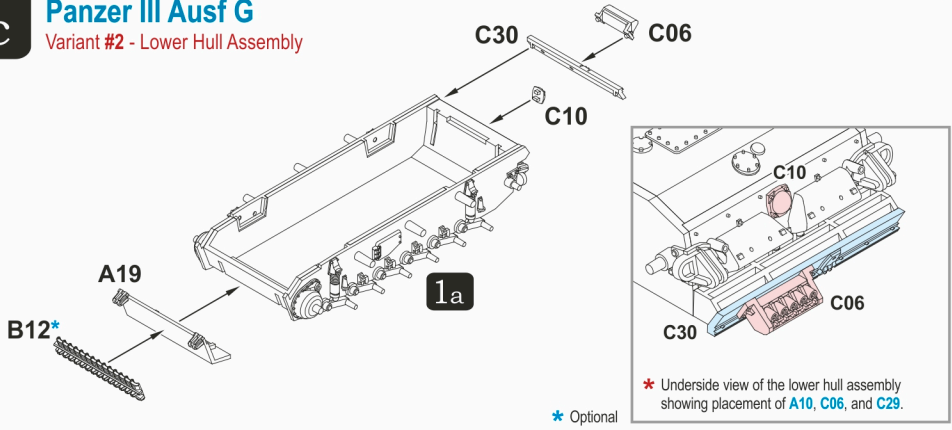

7d

Panzer III Ausf G

Variant #2 - Final Assembly - Skip to Step 9

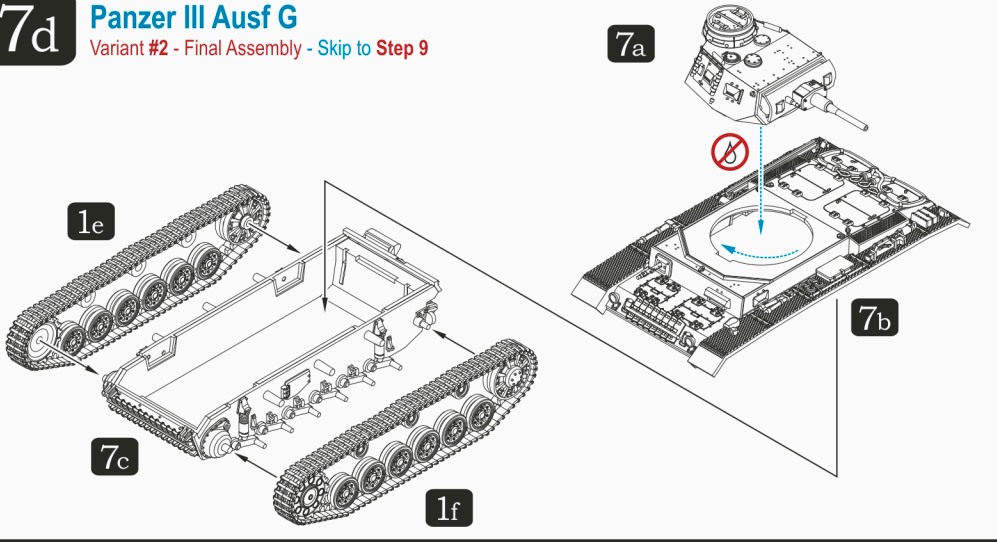

8a

Panzer III Ausf G

Variant #3 - Turret Assembly

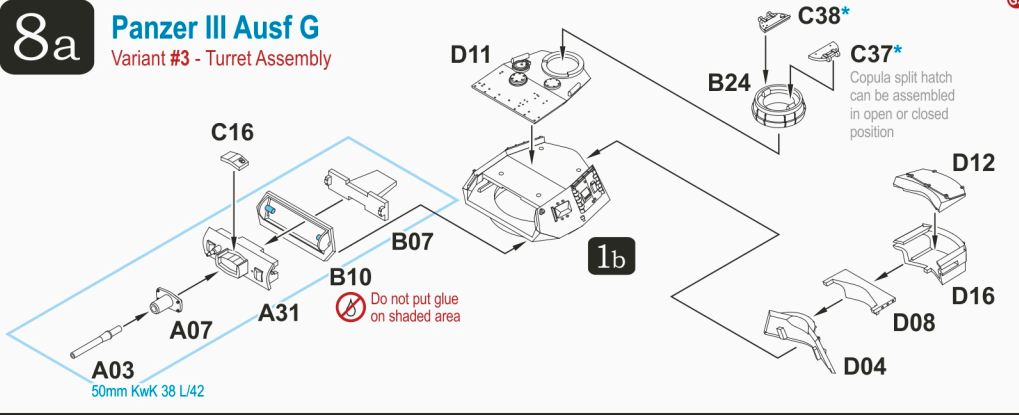

8b

Panzer III Ausf G

Variant #3 - Upper Chassis Assembly

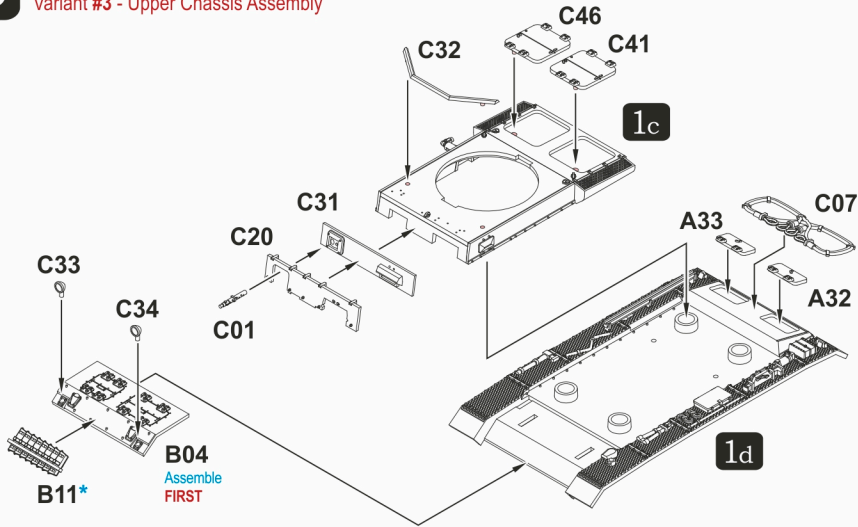

* Optional

8c

Panzer III Ausf G

Variant #3 - Lower Hull Assembly

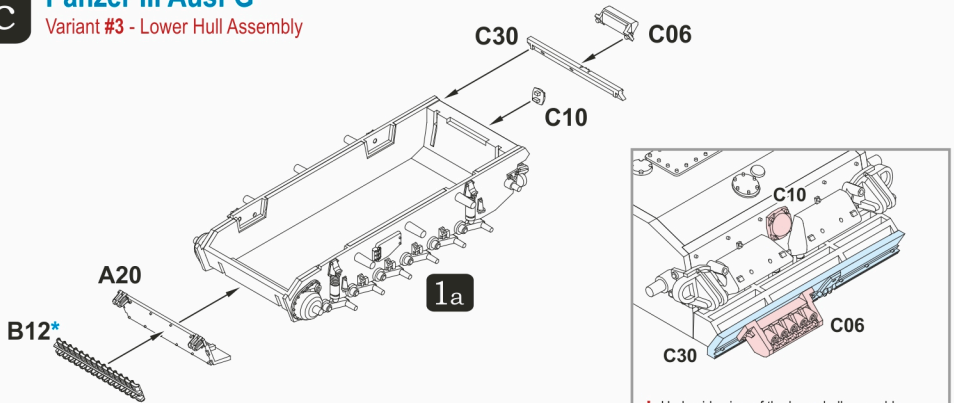

* Underside view of the lower hull assembly showing placement of A10, C06, and C29.

* Optional

If you like this Panzer III early-war tank, you might also want to take a look at our other Panzer III & Panzer IV medium tank offerings, including:

- 280076 Panzer IV Ausf D / E (early war)
- 280077 Panzer IV Ausf F / F2 / G / H (mid-war)
- 280078 Panzer IV Ausf J (late war)
- 280092 Panzer III Ausf H / J / L / M / N (mid-war)
- 280093 Panzerbefehlswagen III Ausf E / H / J / L (command tank)

For more info, please visit our regional webstores and official Facebook page.



Please visit our official Facebook page at
<https://www.facebook.com/rubiconmodels>



Follow our Facebook page
 to show your support!



Panzer III Ausf G
 Medium Tank

8d Panzer III Ausf G

Variant #3 - Final Assembly

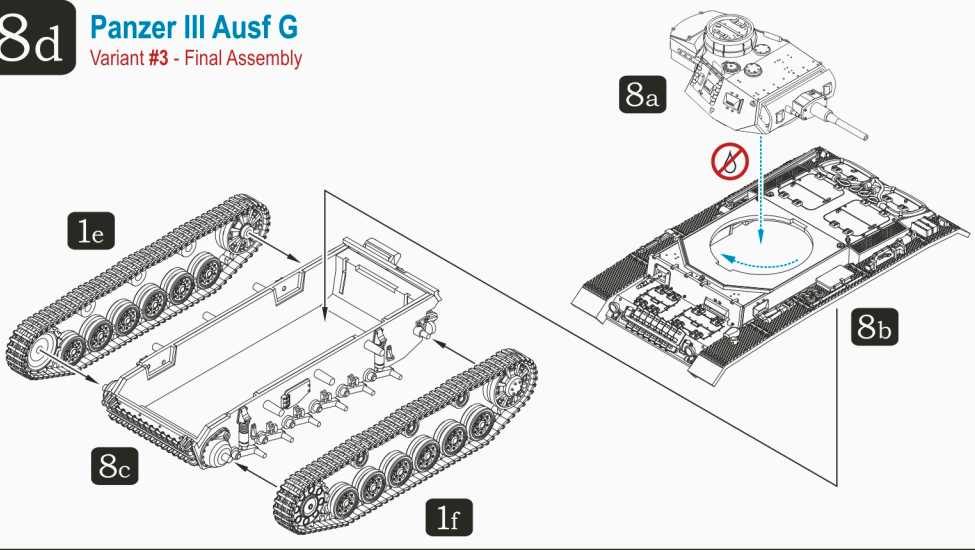

9 Panzer Crew

Optional

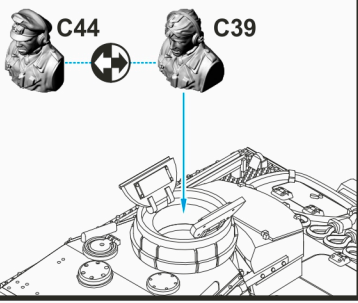

10 Optional Antenna

Not Included

* Use 0.5mm copper or plastic rod and attach to the antenna mount A05, F14, or F15

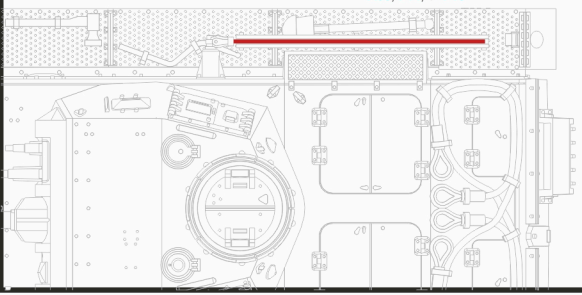

Panzerkampfwagen III Production - Medium Tank								
Ausführung	E	F	G	H	J	L	M	N
Year	1939	1939 - 41	1940/41	1940/41	1941/42	1941/42	1943/43	1942/43
Produced	96	450	594	286	1,521	1,470	517	614

- 280091 Panzer III Ausf E / F / G
- 280092 Panzer III Ausf H / J / L / M / N
- 280093 Panzerbefehlswagen III Ausf E / H / J / L / K

Command Tank & Flammpanzer					
Ausführung	E	H	J	K	Flamm
Year	1939/40	1940/41	1941/42	1942/43	1943
Produced	45	175	81	50	100

- Ausf E** Fifth version of the Panzer III with 30mm armour all-round, other than the rear of the vehicle, with increased weight to 20t. Suspension redesigned, switching from leaf-springs to torsion-bars, using six larger road wheels per side. Had a 300 PS HL 120 engine.
- Ausf F** Improved Ausf E, first mass-production version, late production armed with 5cm KwK 38 L/42 main gun.
- Ausf G** Ausf F with extra armour on the gun mantlet, late production armed with 5cm KwK 38 L/42 main gun.

- Ausf H** 5cm KwK 38 L/42 as standard gun. Bolt-on armour added to front and rear hull (30mm base + 30mm plates).
- Ausf J** The most common variant of the Panzer III, which served in North Africa and the Eastern Front. Hull and turret front armour increased to solid 50mm plate. Spaced armour was placed around the gun mantlet. Some were produced with 5cm KwK 39 L/60 gun and later re-designated as Ausf L.
- Ausf L** Re-designated Ausf J equipped with long 5cm gun, 20mm stand-off armour plates on hull and turret front.
- Ausf K** Panzerbefehlswagen command tank variant based on the Ausf M with a modified turret. Carried actual main armament rather than a dummy gun as found on other Panzer III command versions.
- Ausf M** Minor modifications of the Ausf L such as deep-wading exhaust and Schürzen side-armour panels.
- Ausf N** Infantry support tank, armed with a short-barrelled 7.5cm KwK 37 L/24 gun. 700 were produced or re-equipped from 1942 and 1943.

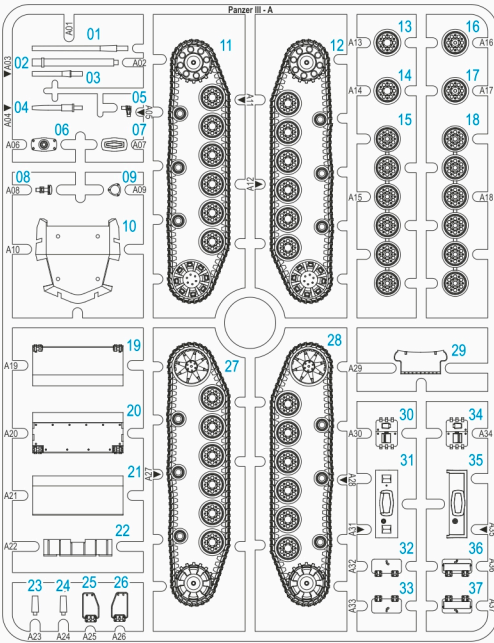

A

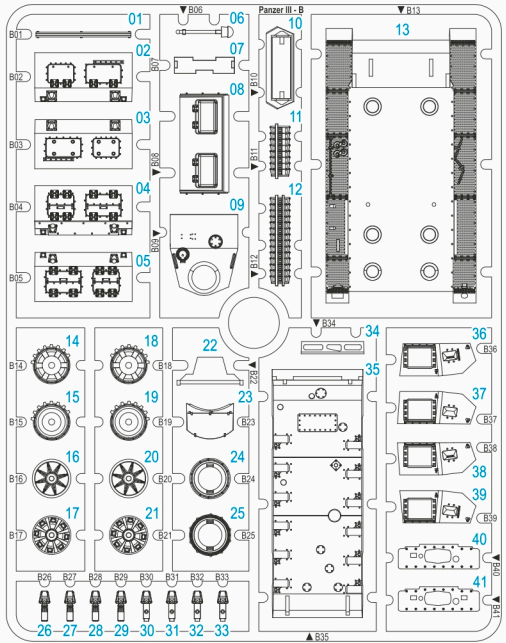

B

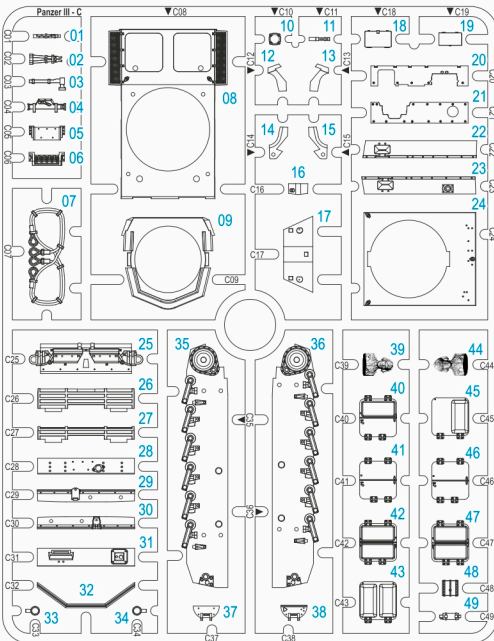

C

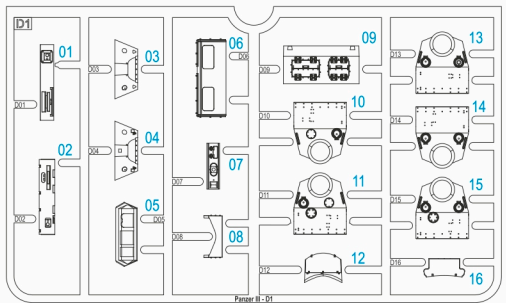

D

German Early War Panzer Crew (284184)

This optional pack contains enough parts that can be assembled into 3 multi-pose Panzer crew in early war uniform.

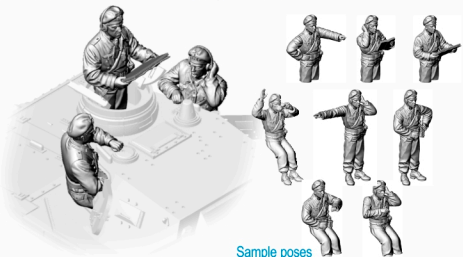

Sample poses