

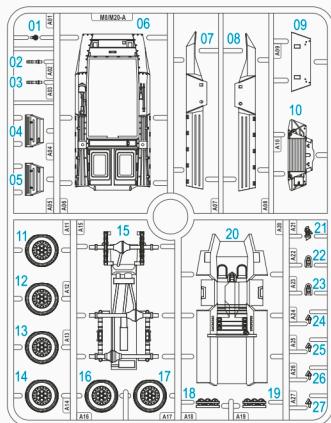

Product Code: 280028

220503-1



A

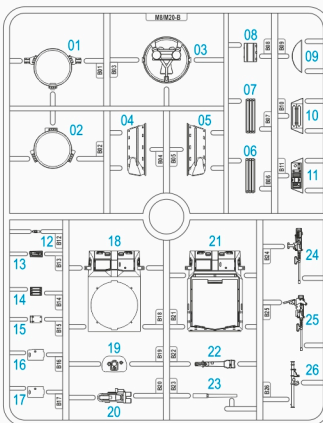

B



- When you use glue or paint, do not use near a naked flame, and use in a well-ventilated area.
- When assembling this kit, tools including knives are used. Extra care should be taken to avoid personal injury.
- Keep out of reach of small children.

Read carefully and fully understand the instructions before commencing assembly. Model supplied unpainted. Bases, scenery, glue and paint not included. Legend used:



Choices



Optional



No glue



Drill hole



Bend



Cut or trim with care

 Please use **ABS Plastic Cement** for our plastic kits.

WARNING

- THIS IS NOT A TOY
- INTENDED FOR COLLECTORS OF AGE 14 AND ABOVE
- CONTAINS SMALL PARTS AND POINTED COMPONENTS
- NOT SUITABLE FOR CHILDREN UNDER 6 YEARS OLD
- MODEL MAY VARY FROM IMAGE ON BOX
- READY TO ASSEMBLE PRECISION MODEL KIT

1

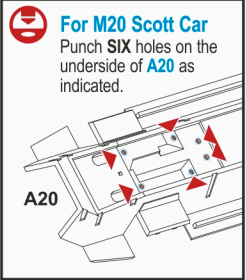
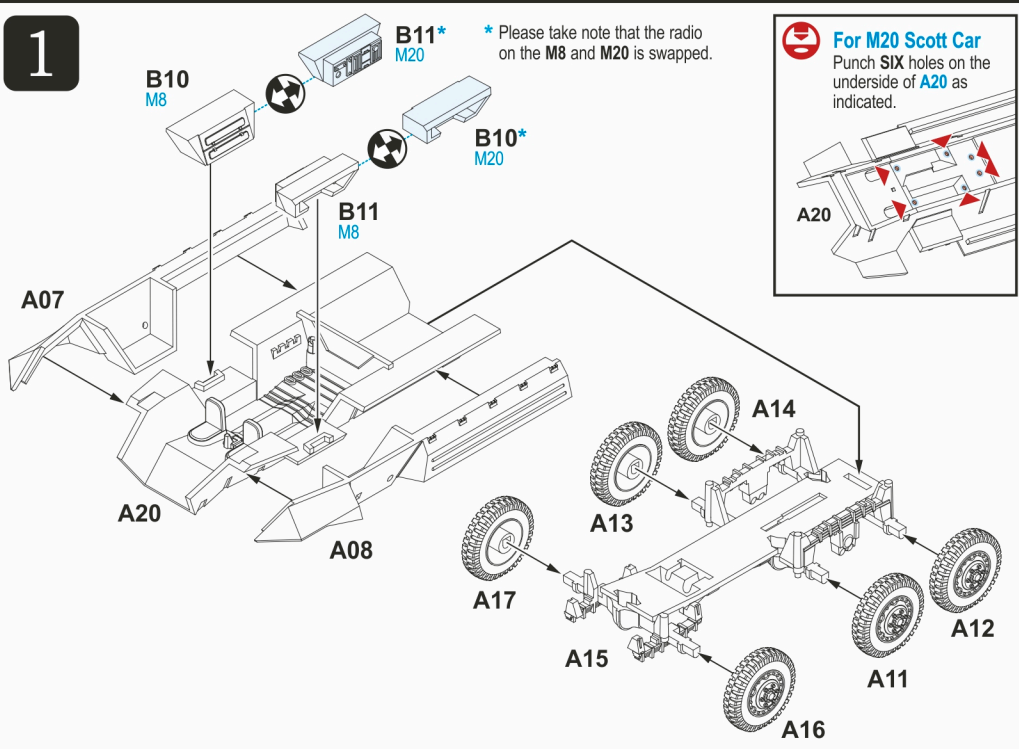

2

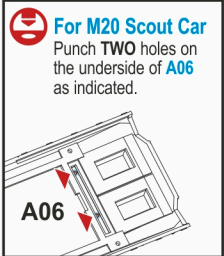
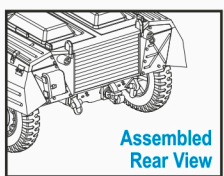
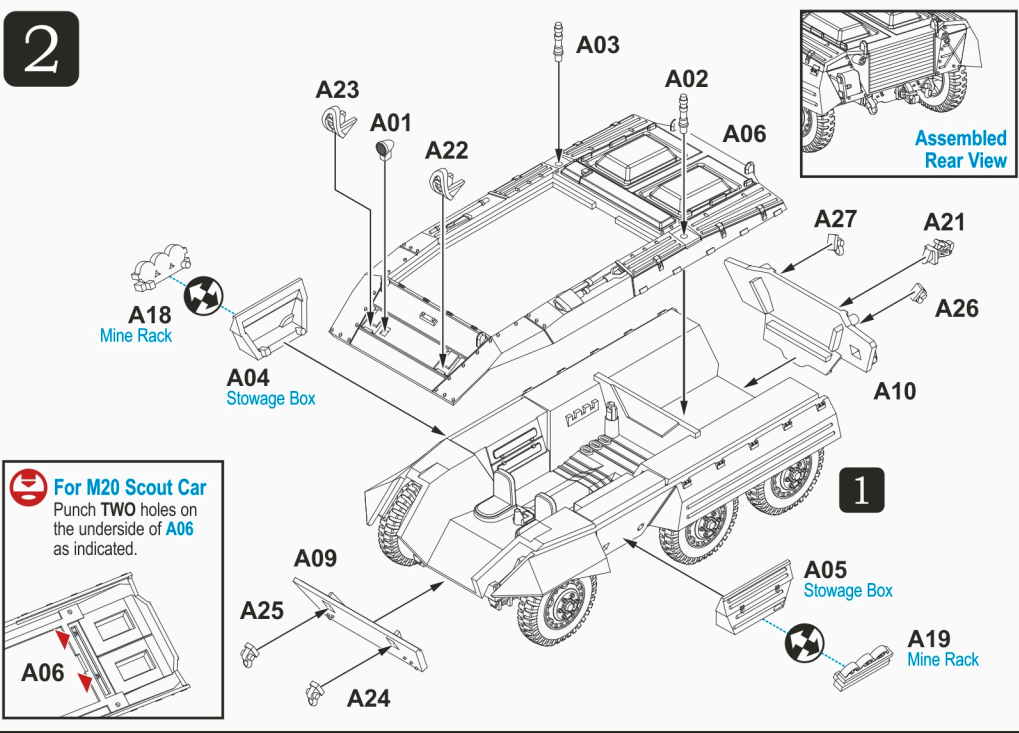

3 M8 Turret

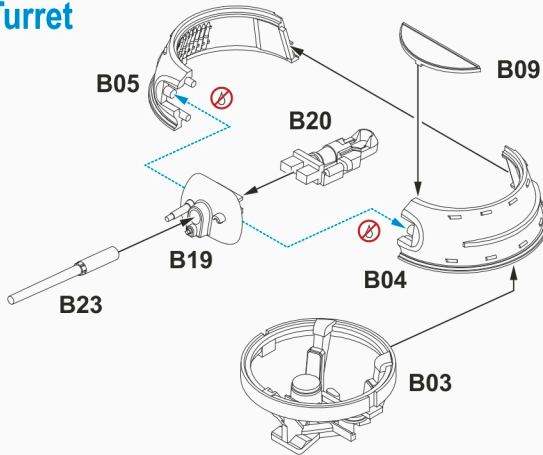

For Early Production M8 Greyhounds

Punch **ONE** hole from the underside of **B09** as indicated.



4a M8 Turret Early Production

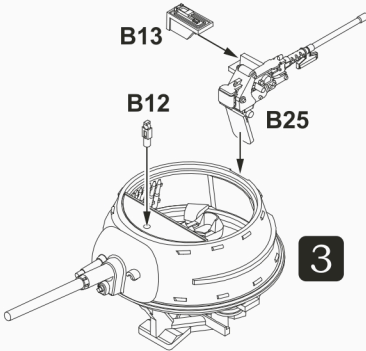

4b M8 Turret Late Production

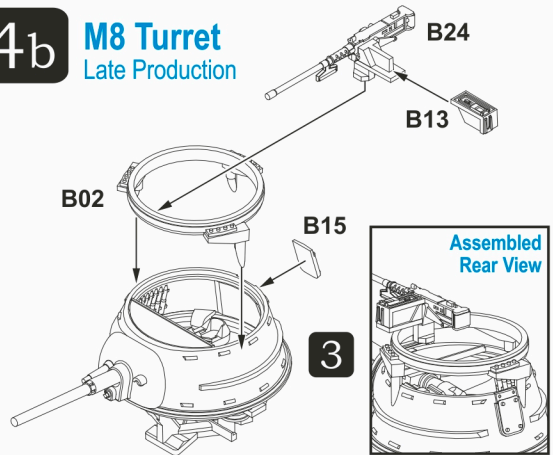

4c M8 Greyhound Final Assembly

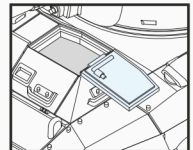
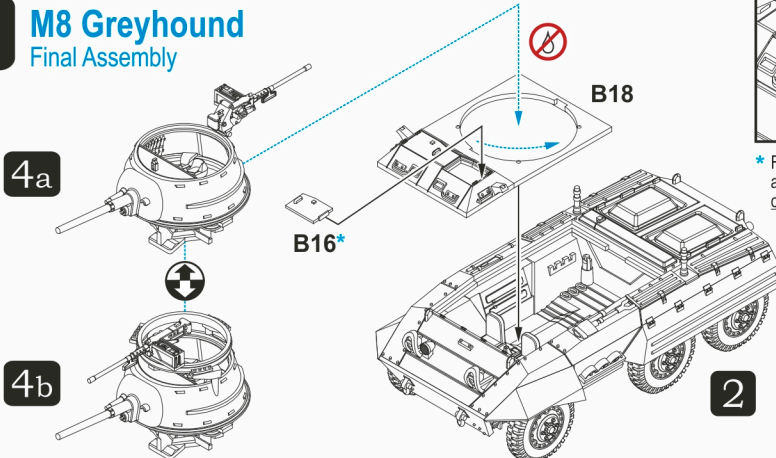

* Front Hatch **B16** can be assembled in open or closed position.

5a

M20 Scout Car Basic Chassis Assembly

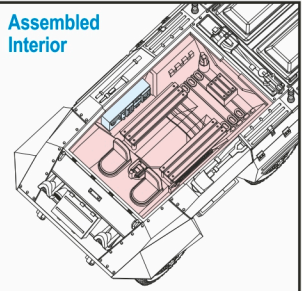
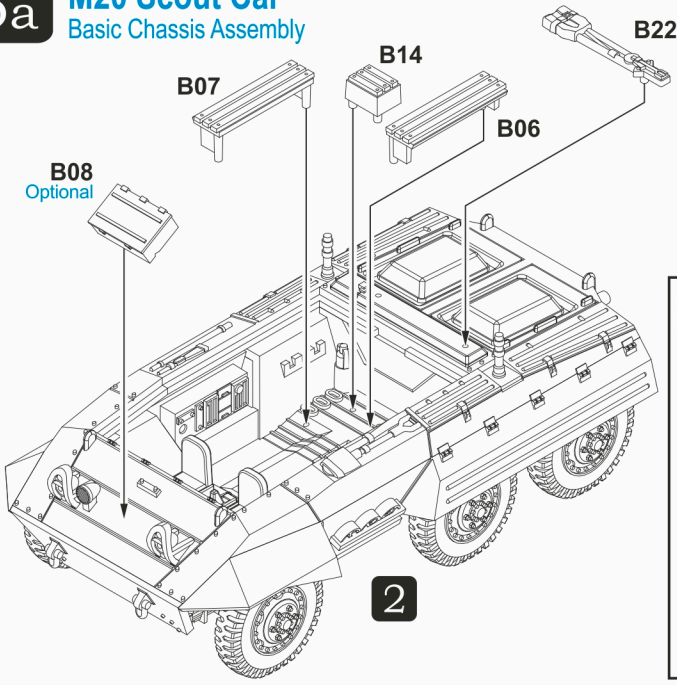

Please make sure the radio **B11** is on the **right hand side** of the interior.
You should also paint the interior first **BEFORE** gluing the top **B21** onto the chassis.

5b

M20 Scout Car Final Assembly

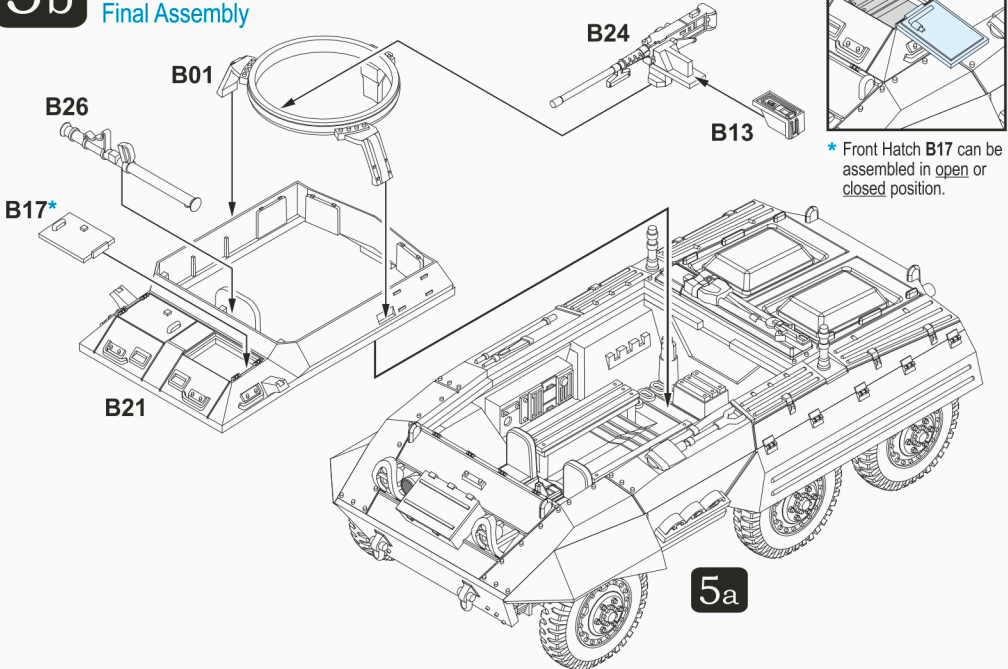

* Front Hatch **B17** can be assembled in **open** or **closed** position.