

Product Code: 280024

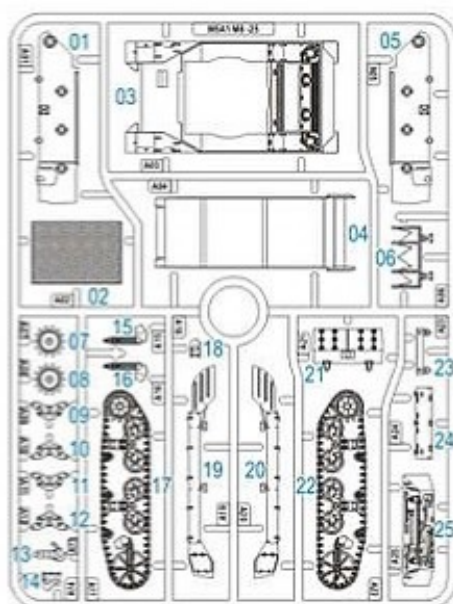

A

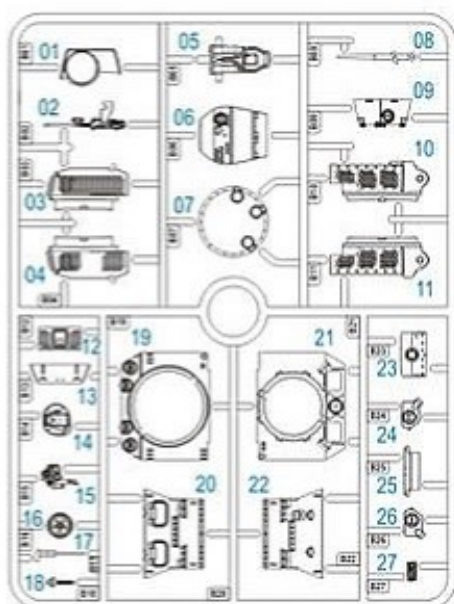

B



CAUTION

- When you use glue or paint, do not use near a naked flame, and use in a well-ventilated area.
- When assembling this kit, tools including knives are used. Extra care should be taken to avoid personal injury.
- Keep out of reach of small children.

Read carefully and fully understand the instructions before commencing assembly. Model supplied unpainted. Bases, scenery, glue and paint not included. Meaning of symbols used:



Choices



Optional



No glue



Drill hole



Bend

WARNING:

Contains small parts which may be hazardous to children under 14 years of age.



1a

M8 Scott 75mm Howitzer

Designer Notes:

After attaching the howitzer (B05) to the turret, you might find the gun, besides able to move up and down, can also sway a little bit sideways. This is normal... as the real howitzer can also do so in combat situations.

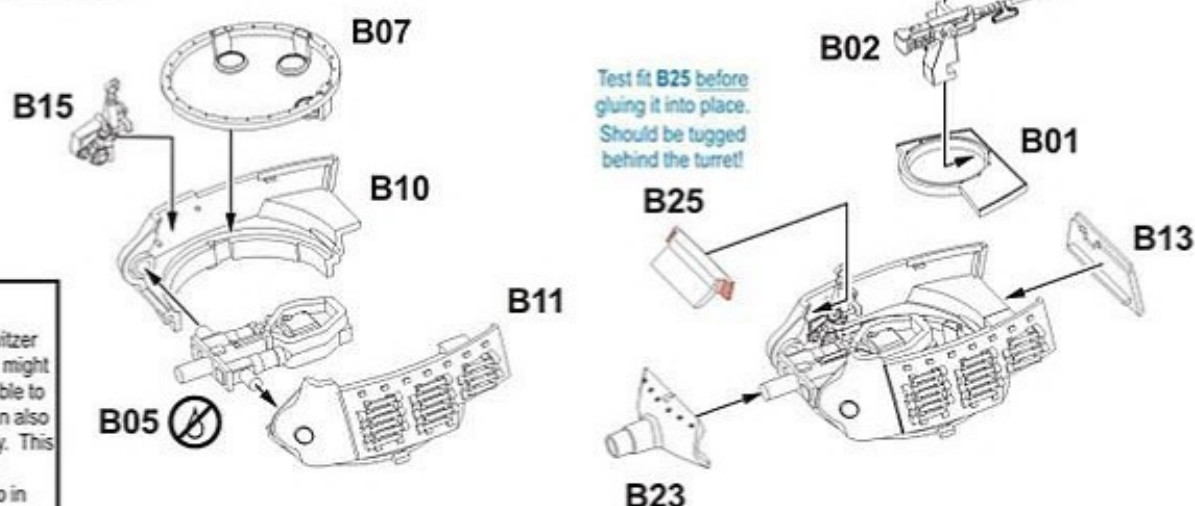

1b

M5A1 Stuart (Mid Production) 37mm M6 Gun

OPTION: Cut B09 in halves to allow the hatches to be glued in open or close position.

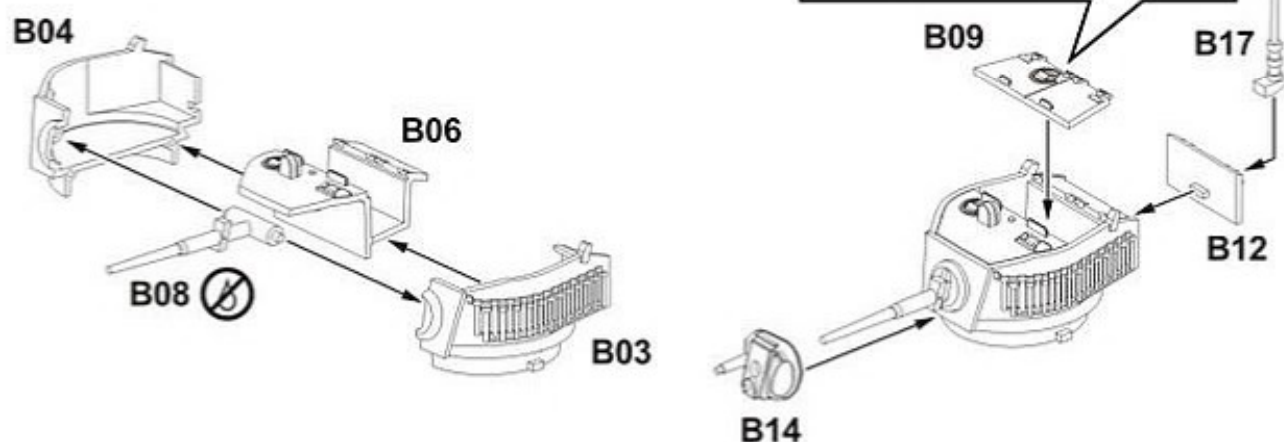

2

R

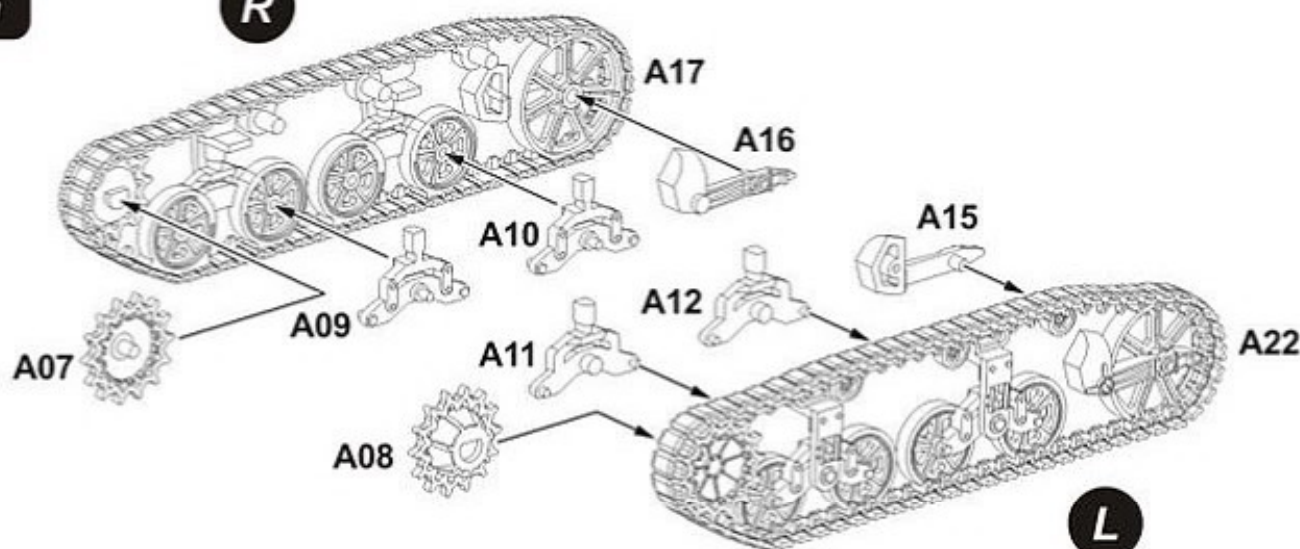

M5A1 Stuart
Mid Production

Diagram illustrating the assembly of the M5A1 Stuart tank chassis, showing various components and their assembly points:

- A19 ***: Hull side armor plate.
- B24 ***: Engine compartment latch (left).
- B26 ***: Engine compartment latch (right).
- A24**: Engine compartment cover.
- B21**: Engine compartment support bracket.
- A25**: Engine compartment side armor plate.
- A18**: Engine compartment side armor plate (lower).
- B22**: Engine compartment side armor plate (lower).
- B18**: Engine compartment side armor plate (lower).
- B16 ***: Engine compartment side armor plate (lower).
- A14**: Engine compartment side armor plate (lower).
- A03**: Engine compartment side armor plate (lower).
- A20 ***: Engine compartment side armor plate (lower).

OPTION: The B24 & B26 can be used to open or close the engine compartment.

* Optional

OPTION: The Crew Hatches B24 & B26 can be glued in open or close position.

5a

M8 Scott

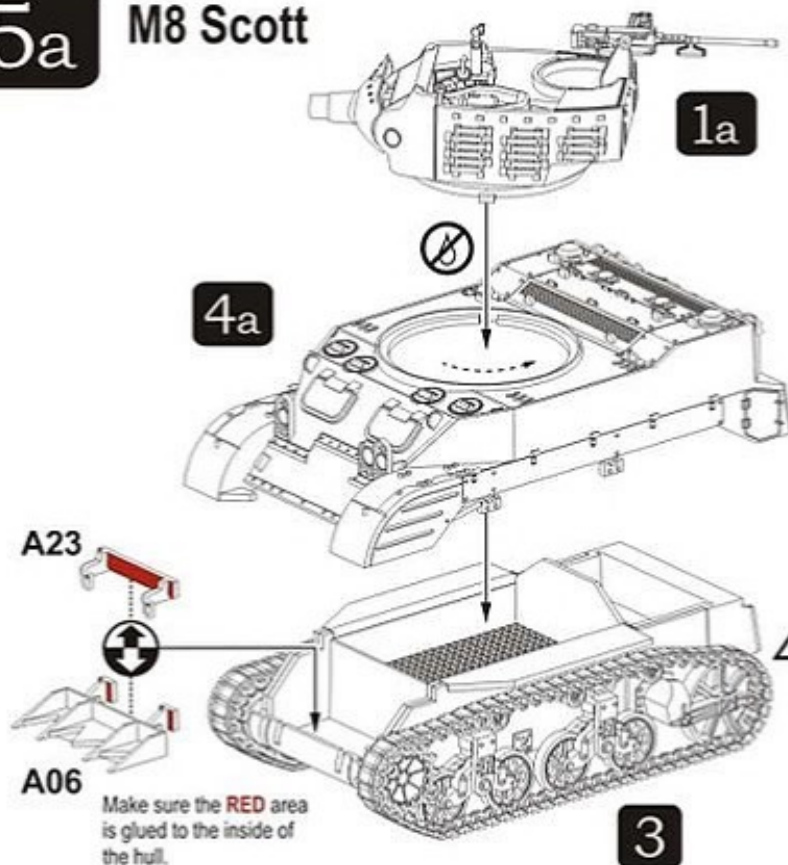

Modelling Tips / Designer Notes:

This **M8 Scott** is modelled as a mid production armoured vehicle, but if you have purchased our **M5A1 Stuart** (280023), you can upgrade this M8 Scott to become a late production model. The parts are designed to be fully compatible with each other.

If you own both kits, you can experiment with different configurations based on your modelling or gaming needs.

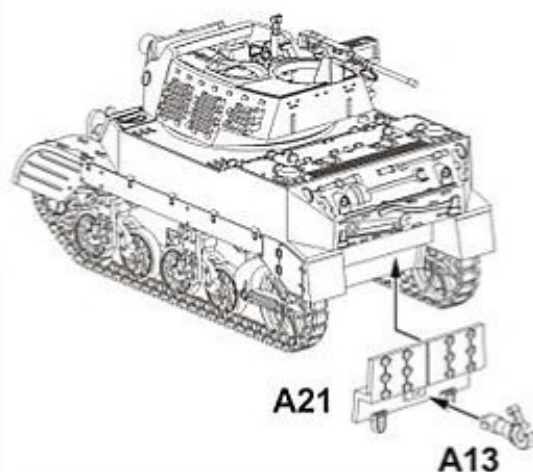
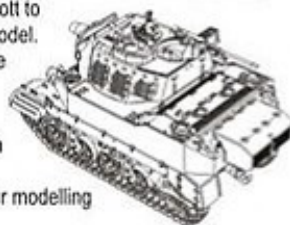

For new project updates, please visit our official forum at <http://forum.rubiconmodels.com/index.php> or visit our website at www.rubiconmodels.com for more info.



Please visit our Facebook page at <https://www.facebook.com/rubiconmodels>



and like our page to show your support!

5b

M5A1 Stuart Mid Production

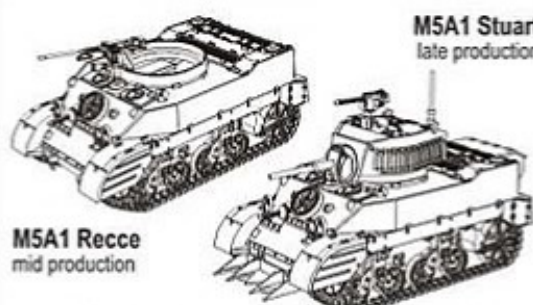
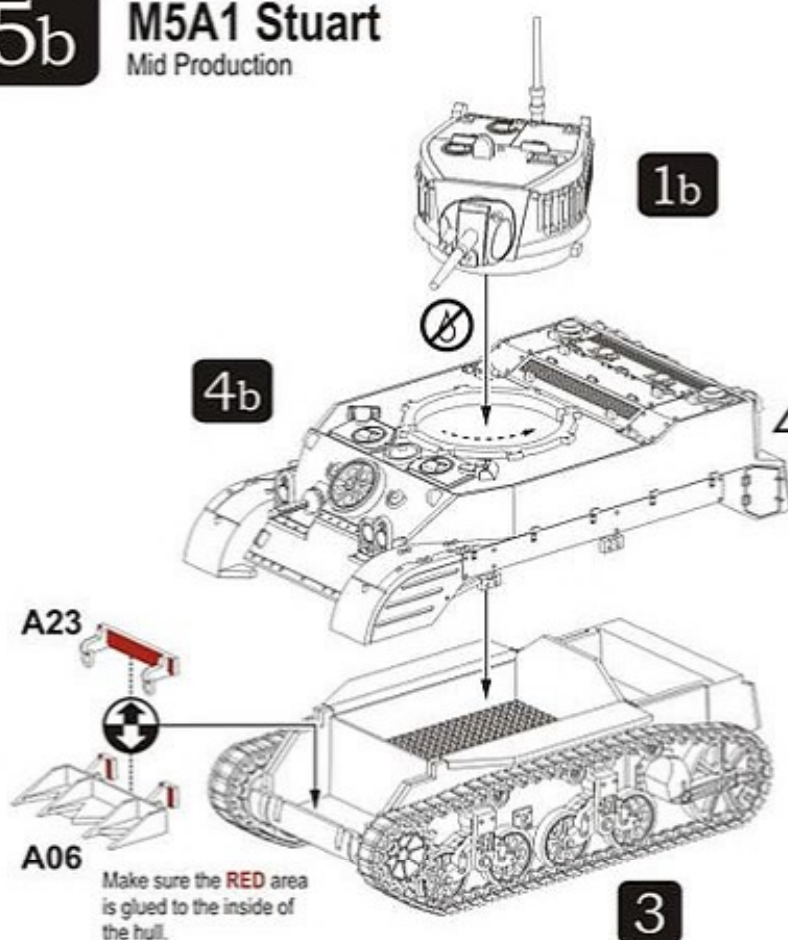

If you like this **M8 Scott** kit, you might also want to look at our 280023 **M5A1 Stuart / M5A1 Recce** (mid & late production) kit.