

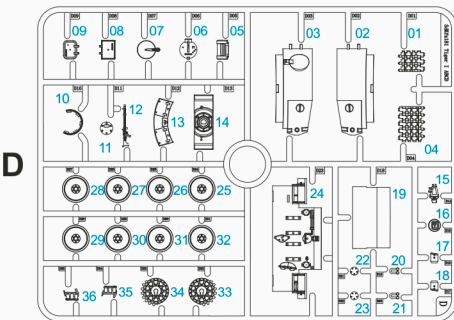
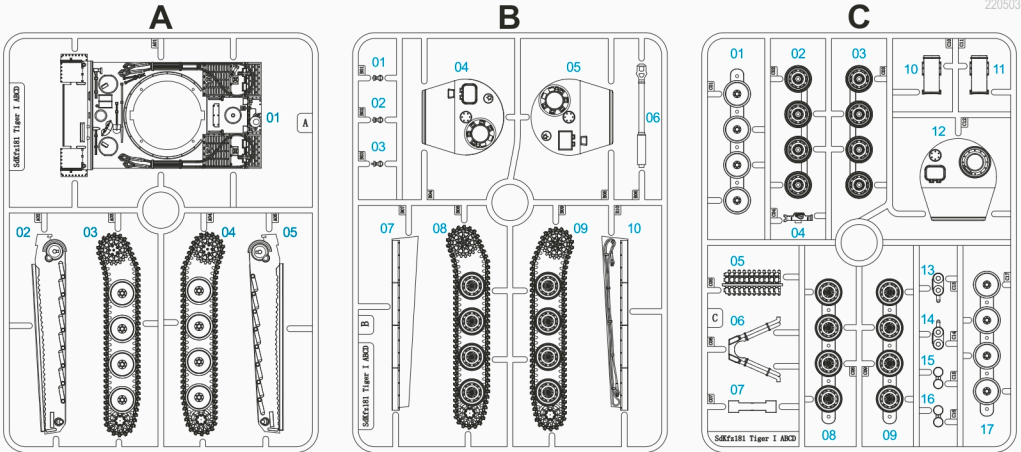

Product Code: 280016

220503-1

NOTE: Please use **ABS Plastic Cement** for our products.

- When you use glue or paint, do not use near a naked flame, and use in a well-ventilated area.
- When assembling this kit, tools including knives are used. Extra care should be taken to avoid personal injury.
- Keep out of reach of small children.

Read carefully and fully understand the instructions before commencing assembly. Model supplied unpainted. Bases, scenery, glue and paint not included. Legend used:

- Choices
- Optional
- No glue
- Drill hole
- Bend
- Cut or trim with care

© Rubicon Models Ltd 2018, 2022. Rubicon Models, the Rubicon Models Logo are trademarks of Rubicon Models Ltd. All rights reserved.

WARNING

- THIS IS NOT A TOY • INTENDED FOR COLLECTORS OF AGE 14 AND ABOVE • CONTAINS SMALL PARTS AND POINTED COMPONENTS • NOT SUITABLE FOR CHILDREN UNDER 6 YEARS OLD • MODEL MAY VARY FROM IMAGE ON BOX • READY TO ASSEMBLE PRECISION MODEL KIT

1a

Steel Road Wheels

For **Mid & Late** Production Tigers

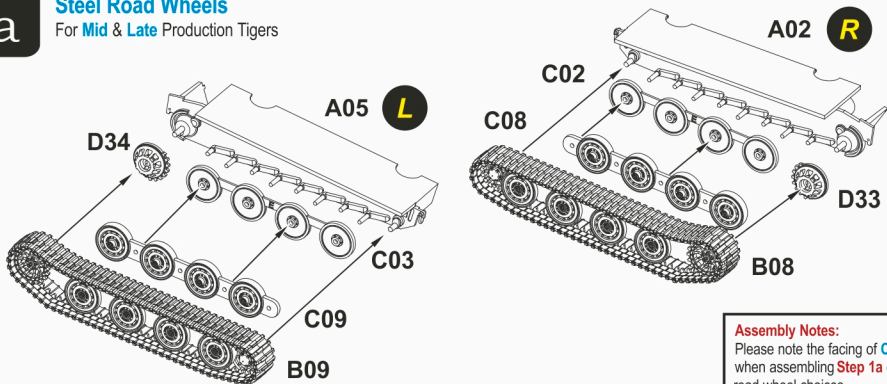

Assembly Notes:
Please note the facing of **C02** & **C03** when assembling **Step 1a** or **Step 1b** road wheel choices.



1b

Rubber Road Wheels

For **Early** Production Tigers

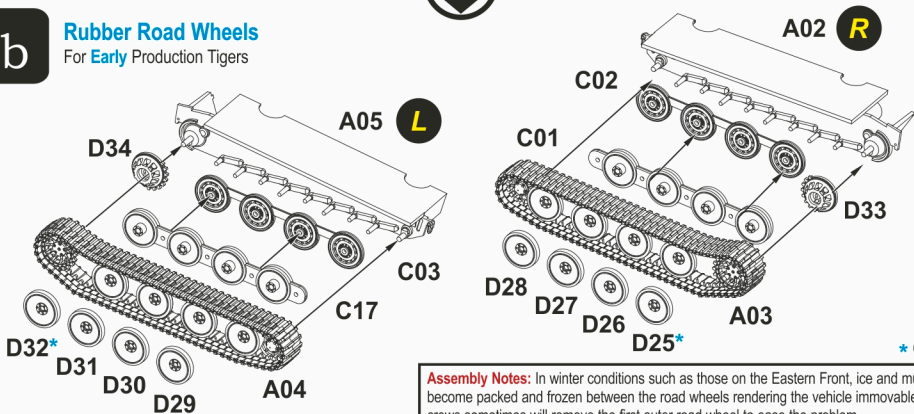

* Optional

Assembly Notes: In winter conditions such as those on the Eastern Front, ice and mud could become packed and frozen between the road wheels rendering the vehicle immovable. Tank crews sometimes will remove the first outer road wheel to ease the problem.

2

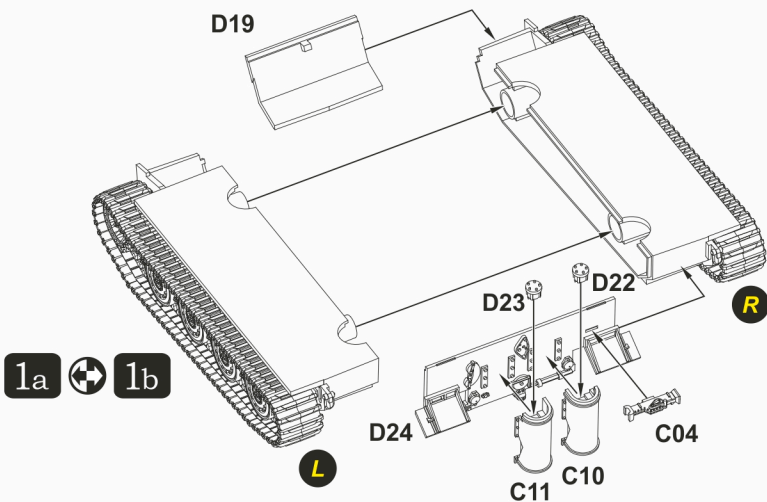

1a 1b

3

Turret Top Choices

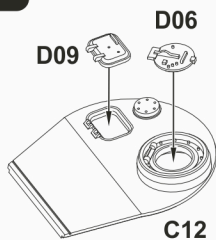

Early Production

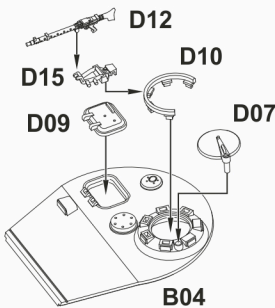

Mid Production

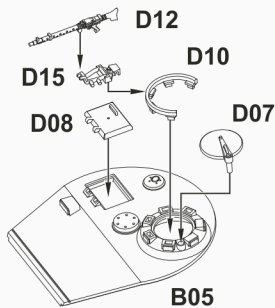

Late Production

4

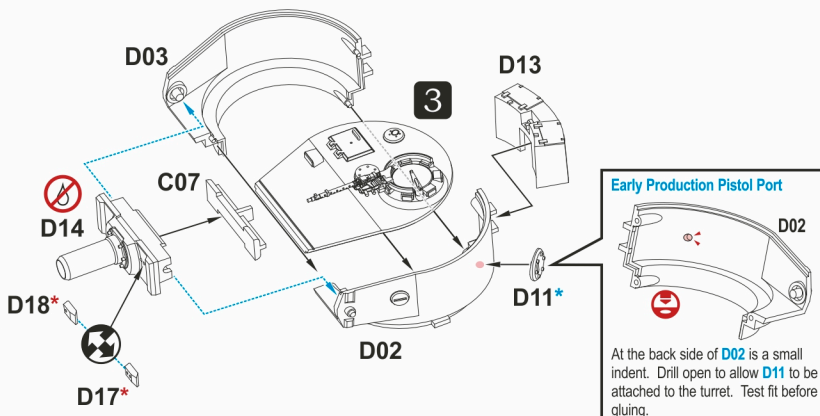

Gun Sight Choices:

Early Production - NONE

Mid Production - D17

Late Production - D18

Early Production Pistol Port

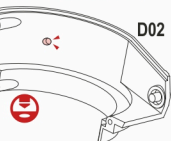

At the back side of D02 is a small indent. Drill open to allow D11 to be attached to the turret. Test fit before gluing.

5

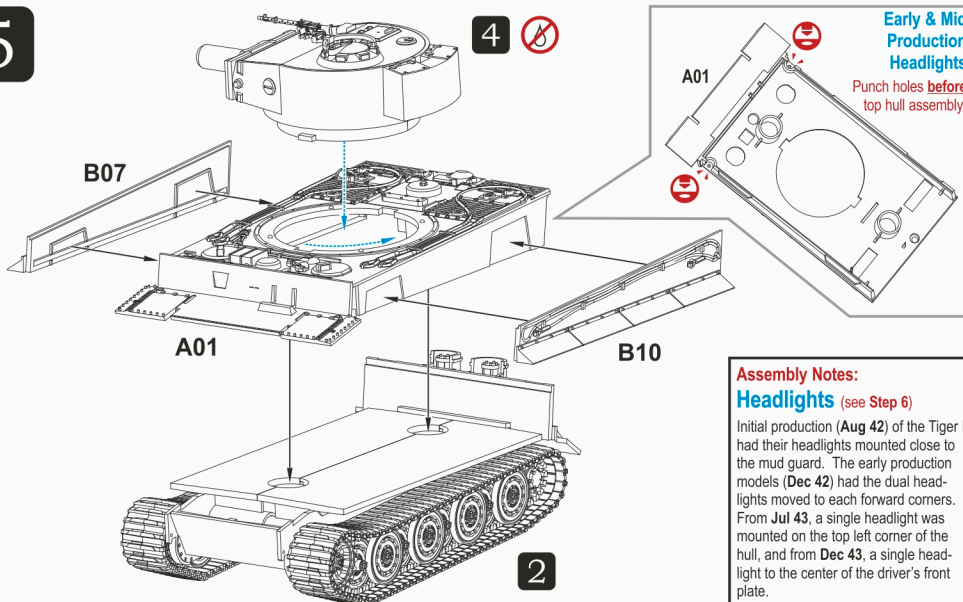

Early & Mid Production Headlights

Punch holes before top hull assembly!

Assembly Notes:

Headlights (see Step 6)

Initial production (Aug 42) of the Tiger I had their headlights mounted close to the mud guard. The early production models (Dec 42) had the dual headlights moved to each forward corners. From Jul 43, a single headlight was mounted on the top left corner of the hull, and from Dec 43, a single headlight to the center of the driver's front plate.

6

Optional Spare Tracks - Slightly bend the tracks into a curve and fit them onto the turret.

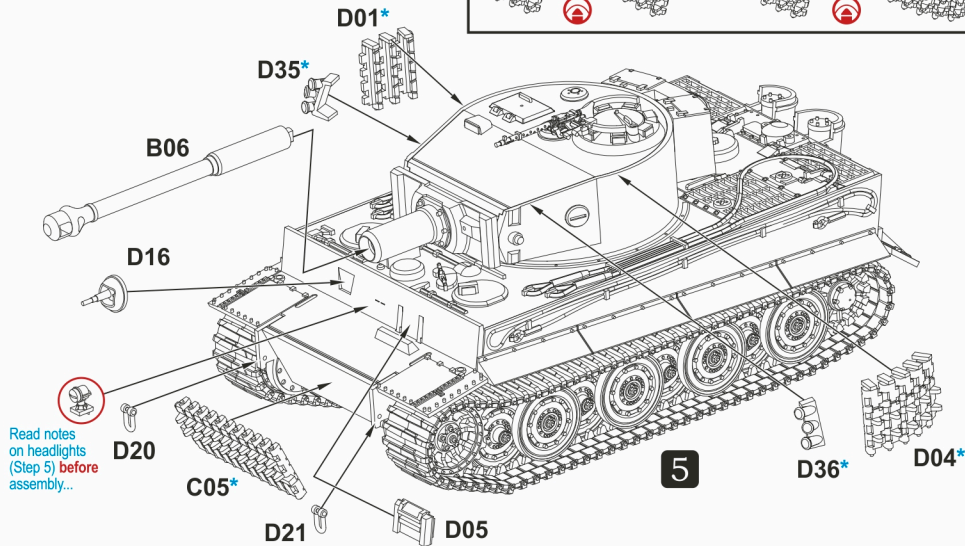

Read notes on headlights (Step 5) before assembly...

* Optional

Initial Production

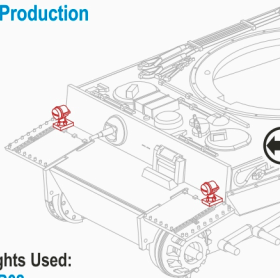

Headlights Used:
B01 & B02

Early / Mid Production

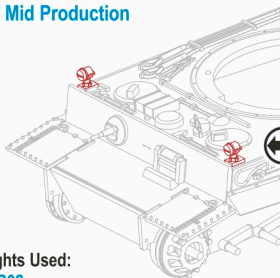

Headlights Used:
B01 & B02

Late Production

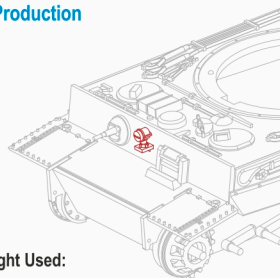

Headlight Used:
B03

7

Optional Feifel Filters for Initial & Early Production Tigers

Assembly Notes: Feifel Filters

From Nov 42, for Tigers sent to regions like Tunisia, Sicily, Italy, Heeresgruppe Süd and Mitte in Russia, Feifel air pre-cleaners were installed.

After Aug 43, these were no longer fitted at the factory.

